



Your PDF Guides

You can read the recommendations in the user guide, the technical guide or the installation guide for POLAROID SPECTRA 1200 FF. You'll find the answers to all your questions on the POLAROID SPECTRA 1200 FF in the user manual (information, specifications, safety advice, size, accessories, etc.). Detailed instructions for use are in the User's Guide.

User manual POLAROID SPECTRA 1200 FF
User guide POLAROID SPECTRA 1200 FF
Operating instructions POLAROID SPECTRA 1200 FF
Instructions for use POLAROID SPECTRA 1200 FF
Instruction manual POLAROID SPECTRA 1200 FF

Spectra 1200FF Instructions



Open Camera

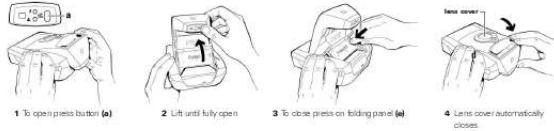

Load Film (Important: Always load film pack with camera open!)

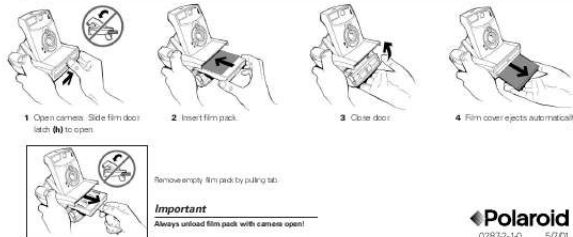

Polaroid
02872-10 5/7/01



[You're reading an excerpt. Click here to read official POLAROID SPECTRA 1200 FF user guide](http://yourpdfguides.com/dref/1222098)
<http://yourpdfguides.com/dref/1222098>

Manual abstract:

Always unload film pack with camera open! Note: If green light (b) is off, lightly touch The red close-up light (d) turns on. Return switch to normal position close-up picture is taken. Blurry Picture Cause Too close Solution If less than 4 ft (1. Spots on Pictures Cause Dirty rollers Subject moves Make sure subject is not moving in low light levels. solution Open camera. Openfilm door and clean rollers with damp cloth. Beyond flash range Stand between 4 - 10 ft. If this camera proves defective within one year of the original purchase date, Polaroid will, at our option, repair or replace any camera found defective in manufacture within the warranty period. the warranty period is determined by the date of camera purchase. Keep the receipt as proof of purchase.

@@@Avoid contacting skin, eyes, or mouth with the paste. @@Do not cut or take apart photos or battery. Do not burn battery or allow metal to touch its terminals. @@@This camera is powered by batteries contained within the film pack. Supervise children when camera is operated by them or used in their presence.

To avoid electrical shock, do not expose to or immerse in water or other fluids, disassemble, or operate if dropped or damaged. @@.



[You're reading an excerpt. Click here to read official POLAROID SPECTRA 1200 FF user guide](http://yourpdfguides.com/dref/1222098)
<http://yourpdfguides.com/dref/1222098>