



Your PDF Guides

You can read the recommendations in the user guide, the technical guide or the installation guide for PANASONIC KX-MB2030. You'll find the answers to all your questions on the PANASONIC KX-MB2030 in the user manual (information, specifications, safety advice, size, accessories, etc.). Detailed instructions for use are in the User's Guide.

User manual PANASONIC KX-MB2030
User guide PANASONIC KX-MB2030
Operating instructions PANASONIC KX-MB2030
Instructions for use PANASONIC KX-MB2030
Instruction manual PANASONIC KX-MB2030

Panasonic

Important Information Guide

Multi-Function Printer

Model No. **KX-MB2010BL**
KX-MB2030BL

Do NOT connect the unit to a computer with the USB cable until prompted to do so during the setup of Multi-Function Station (CD-ROM).

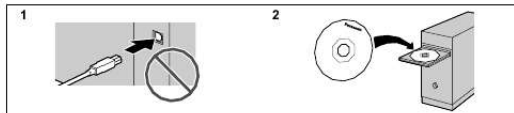

Accessory information:
To ensure that the unit operates properly, we recommend the use of Panasonic toner and drum cartridges.

- **Replacement accessory**
- **Toner cartridge**
 - **Model No. (Part No.): KX-FAT411X**
- **Drum cartridge**
 - **Model No. (Part No.): KX-FAD412X**

The supplied Setup CD-ROM provides the Operating Instructions in PDF format with a detailed description on how to use the unit. Adobe® Reader® is required to view them. Please read before using the unit and save the CD-ROM for future reference.

You can select the English, French or Dutch language.
The display and reports will be in the selected language. The default setting is English. If you want to change the setting, see the operating instructions (feature #110).



[You're reading an excerpt. Click here to read official PANASONIC KX-MB2030 user guide](http://yourpdfguides.com/dref/4576732)
<http://yourpdfguides.com/dref/4576732>

Manual abstract:

KX-MB2010BL KX-MB2030BL Do NOT connect the unit to a computer with the USB cable until prompted to do so during the setup of Multi-Function Station (CD-ROM). 1.2 Accessory information: To ensure that the unit operates properly, we recommend the use of Panasonic toner and drum cartridges. n Replacement accessory – Toner cartridge R Model No. (Part No.): KX-FAT411X – Drum cartridge R Model No. (Part No.): KX-FAD412X The supplied Setup CD-ROM provides the Operating Instructions in PDF format with a detailed description on how to use the unit. Adobe® Reader® is required to view them.

Please read before using the unit and save the CD-ROM for future reference. You can select the English, French or Dutch language.

The display and reports will be in the selected language. The default setting is English. If you want to change the setting, see the operating instructions (feature #110). User record (for your future reference) Date of purchase Serial number (found on the rear of the unit) Dealer's name and address Information of Compliance with EU relevant Regulatory Directives (KX-MB2010 only): R Contact to Authorised Representative: Panasonic Testing Centre Panasonic Marketing Europe GmbH Winsbergring 15, 22525 Hamburg, Germany ENERGY STAR: R As an ENERGY STAR® Partner, Panasonic has determined that this product meets the ENERGY STAR guidelines for energy efficiency. ENERGY STAR is a U.

S. registered mark. Dealer's telephone number Attach your sales receipt here. Note: R Save the original carton and packing materials for future shipping and transportation of the unit. @@@@R Most figures shown in these instructions are based on a KX-MB2010.

Caution: R When you operate this product, the power outlet should be near the product and easily accessible. R Be sure to use the telephone line cord supplied with this unit (KX-MB2030 only). R Do not extend the telephone line cord (KX-MB2030 only). R In the event of problems, you should contact your equipment supplier in the first instance (KX-MB2030 only). @@@@Declarations of Conformity for the relevant Panasonic products described in this manual are available for download by visiting: <http://www.doc.panasonic.de> Contact to Authorised Representative: Panasonic Testing Centre Panasonic Marketing Europe GmbH Winsbergring 15, 22525 Hamburg, Germany Trademarks: R Adobe and Reader are either registered trademarks or trademarks of Adobe Systems Incorporated in the United States and/or other countries. R All other trademarks identified herein are the property of their respective owners. Copyright: R This material is copyrighted by Panasonic System Networks Co.

, Ltd., and may be reproduced for internal use only. All other reproduction, in whole or in part, is prohibited without the written consent of Panasonic System Networks Co., Ltd. © Panasonic System Networks Co., Ltd. 2011 Table of Contents 1.1 For your safety 1.2 Important safety instructions 1.3 Information for Users on Collection and Disposal of Old Equipment and used Batteries 1.

4 Illegal copies 1.5 Turning the power switch ON 1.6 Selecting the operation mode (Scan/ Copy) (Fax: KX-MB2030 only) 1.7 Setting the original 1.8 Display messages 3 5 5 6 6 6 7 7 2 1.

Important Information 1.1 For your safety 1. . @@@@If you do not have this type of outlet, please have one installed. Do not ignore this safety feature by tampering with the plug.

Do not place objects on the power cord. Install the unit where no one can step or trip on the cord. Do not overload power outlets and extension cords. @@@@Regularly remove any dust, etc. @@Accumulated dust may cause an insulation defect from moisture, etc. resulting in a fire. Never touch the plug with wet hands. There is a danger of electric shock. Installation Place the unit securely on a stable, level surface. Serious damage and/or injury may result if the unit falls.

@@Use this unit in a well ventilated area. Particularly, if you will be using the unit for extended periods of time or will be printing in large volumes, be sure to ventilate the room sufficiently. Operating safeguards Turn the power switch OFF before cleaning. Do not use liquid or aerosol cleaners. Do not cover slots and openings on the unit. They are provided for ventilation and protection against overheating. Never place the unit near radiators, or in a place where proper ventilation is not provided. Denotes hazards that could result in minor injury or damage to the unit. R The following symbols are used to classify and describe the type of instructions to be observed. This type of symbol is used to alert users to a specific operating procedure that must be performed carefully. This type of symbol is used to alert users to a specific operating procedure that must not be performed. This type of symbol is used to alert users to a specific operating procedure that must be emphasized in order to operate the unit safely. Power and ground connection Unplug this unit from power outlets if it emits smoke, an abnormal smell or makes unusual noise. These conditions can cause fire or electric shock. Confirm that smoke has stopped and contact an authorised service centre.

Use only the power source marked on the unit. @@@@This may result in the risk of fire or electric shock. Never spill any liquid on the unit. To reduce the risk of electric shock, do not disassemble this unit. @@@@Follow all warnings and instructions marked on this unit.

@@This may cause a fire. @@@@Adjust only controls covered by the operating instructions. @@R If the unit has been dropped or physically damaged. R If the unit exhibits a distinct change in performance. @@R use only shielded LAN cable (category 5 straight cable). @@If the power switch is turned on too soon after a sudden climate change, condensation may form inside the unit, causing malfunction. Never turn the unit upside down or sideways when moving it. Never install telephone wiring during a lightning storm (KX-MB2030 only). Never install telephone jacks in wet locations unless the jack is specifically designed for wet locations (KX-MB2030 only). @@@@Toner cartridge Avoid ingestion, inhalation, eye or skin contact.

@@R If inhalation occurs, exit the area immediately into the fresh air. @@Do not use hot water or hair dryer. R If eye contact occurs, flush thoroughly with water. R In all cases, seek medical treatment if adverse symptoms occur. A A 1.2 Important safety instructions When using this unit, basic safety precautions should always be followed to reduce the risk of fire, electric shock, or personal injury. Laser radiation CLASS 1 LASER PRODUCT The printer of this unit utilises a laser. Use of controls or adjustments or performance of procedures other than those specified herein may result in hazardous radiation exposure.

See the operating instructions for the Laser diodes properties. LED light CLASS 1 LED PRODUCT Do not view directly with optical instruments.

See the operating instructions for the CIS's LED light properties. Fuser unit During or immediately after printing, the fuser unit gets hot.



[You're reading an excerpt. Click here to read official PANASONIC](http://yourpdfguides.com/dref/4576732)

[KX-MB2030 user guide](http://yourpdfguides.com/dref/4576732)

<http://yourpdfguides.com/dref/4576732>

This is normal. Do not touch the fuser unit. Note: R The area near the output tray may also get warm.

This is normal. 1. Do not use this unit near water, for example near a bathtub, wash bowl, kitchen sink, etc. 2. During thunderstorms, avoid using telephones except cordless types.

There may be a remote risk of an electric shock from lightning (KX-MB2030 only). 3. @@@@Penalties may be applicable for incorrect disposal of this waste, in accordance with national legislation. For business users in the European Union If you wish to discard electrical and electronic equipment, please contact your dealer or supplier for further information. Information on Disposal in other Countries outside the European Union These symbols (A, B, C) are only valid in the European Union. If you wish to discard these items, please contact your local authorities or dealer and ask for the correct method of disposal. Note for th.



[You're reading an excerpt. Click here to read official PANASONIC KX-MB2030 user guide](http://yourpdfguides.com/dref/4576732)
<http://yourpdfguides.com/dref/4576732>