



Your PDF Guides

You can read the recommendations in the user guide, the technical guide or the installation guide for HUSQVARNA 42. You'll find the answers to all your questions on the HUSQVARNA 42 in the user manual (information, specifications, safety advice, size, accessories, etc.). Detailed instructions for use are in the User's Guide.

User manual HUSQVARNA 42
User guide HUSQVARNA 42
Operating instructions HUSQVARNA 42
Instructions for use HUSQVARNA 42
Instruction manual HUSQVARNA 42

 **Husqvarna**

Operator's Manual	2008-01 O0803001
----------------------	---------------------

EZ / MZ Collection System (Fab Deck)
42" / 48" / 52" / 61"

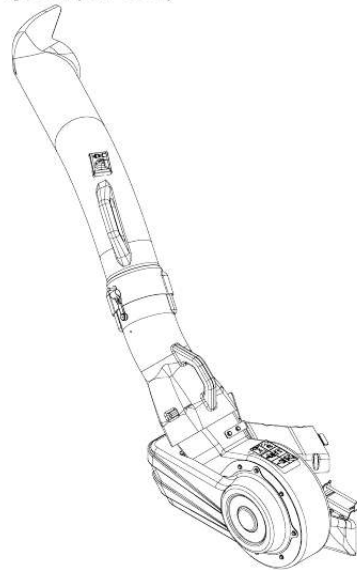

Operator's Manual



[You're reading an excerpt. Click here to read official HUSQVARNA 42 user guide](http://yourpdfguides.com/dref/4735685)

<http://yourpdfguides.com/dref/4735685>

Manual abstract:

.....
.....
.....
.....

.....
.....
.....
.....

.....
.....
.....
.....

.....
.....
.....
.....

...4 CARTON CONTENTS

.....
.....
.....

.....
.....
.....
.....

.....
.....
.....
.....

.....
.....
.....

.....7 ASSEMBLY ..

.....
.....
.....
.....

.....
.....
.....
.....

.....
.....
.....
.....

.....
.....
.....
.....

.....8 OPERATION.

.....
.....
.....

.....
.....
.....
.....

.....
.....
.....
.....

.....
.....
.....
.....

.....
.....
.....
.....

..16 CUSTOMER RESPONSIBILITIES ...

.....
.....
.....
.....

.....
.....
.....
.....

.....
.....
.....
.....

.17 PARTS

.....
.....
.....
.....

.....
.....
.....
.....

.....
.....
.....
.....

.....
.....
.....
.....

.....18 CONGRATULATIONS on your purchase of a new collection system. It has been designed, engineered and manufactured to give you the best possible dependability and performance.

Should you experience any problem you cannot easily remedy, please contact your nearest authorized service center/ department. They have competent, well-trained technicians and the proper tools for service and repairs. Please read and retain this manual. The instructions will enable you to assemble and maintain your collection system properly. Always observe the "SAFETY RULES".

KNOW YOUR BLOWER SYSTEM READ THIS OPERATION MANUAL AND SAFETY RULES BEFORE ASSEMBLING OR OPERATING YOUR BLOWER SYSTEM. Compare the illustrations with the carton contents to familiarize yourself with the parts before starting the assembly. Study the operating instructions and safety precautions thoroughly to insure proper functioning of your Grass Catcher and to prevent injury to yourself and others. Save this manual for future reference. **WARNING** The operation of any mower can result in foreign objects thrown into the eyes, which can result in severe eye damage. **ALWAYS** wear safety glasses or eye shields before starting your mower and while mowing. @@@@ Clear the area of objects such as rocks, stones, toys, wire etc., which could be picked up and thrown by the blades. Be sure the area is clear of all people and pets before mowing. Stop the machine if anyone enters the area. Never carry passengers or children even with blades off. Do not mow in reverse unless absolutely necessary. Always look down and behind

before and while backing. Be aware of the mower discharge direction and do not direct it towards anyone. Do not operate the mower without either the entire grass catcher or the guard in place.

Slow down before turning. Never leave the machine unattended when the engine is running. Always turn off the blades, set the parking brake, stop the engine and remove the key before leaving the machine. Turn off blades when not mowing. Stop engine before removing grass catcher or unclogging chute. Mow only in daylight or good artificial light. Do not operate the machine while under the influence of alcohol or drugs. Watch out for traffic when operating near or crossing roadways. Use extra care when loading and unloading the machine onto a trailer or truck. • Data indicates that operators, age 60 years and above, are involved in a large percentage of riding mower-related injuries.

These operators should evaluate their ability to operate the riding mower safely enough to protect themselves and others from serious injury. DO NOT operate mower with grass catcher, unless the front weights are installed. Keep machine free of grass, leaves or other debris buildup which can touch hot exhaust/ engine parts and burn. Do not allow the mower deck to plow leaves or other debris which can cause buildup to occur. Clean any oil or fuel spillage before operating or storing the machine.

Allow machine to cool before storage. •••••II. SLOPE OPERATION Slopes are a major factor related to loss-of-control and tip-over accidents, which can result in severe injury or death. All slopes require extra caution. If you cannot back up the slope or if you feel uneasy on it, do not mow it.

••••••••DO •Mow up and down slopes (10° Max.), not across. •Remove obstacles such as rocks, tree limbs, etc. •Watch for holes, ruts, or bumps. Uneven terrain could overturn the machine. Tall grass can hide obstacles. •Use slow speed. Choose a low speed so that you will not have to stop while on the slope. •Use extra care with grass catchers or other attachments. These can change the stability of the machine.

•Keep all movement on the slopes slow and gradual. Do not make sudden changes in speed or direction. •Avoid starting or stopping on a slope. 4 SAFETY RULES SAFE OPERATION PRACTICES FOR RIDE-ON MOWERS DO NOT •Do not turn on slopes unless necessary, and then, turn slowly and gradually downhill, if possible. •Do not mow near drop-off, ditches, or embankments. The mower could suddenly turn over if a wheel is over the edge of a cliff or ditch, or if an edge caves in. •Do not mow on wet grass. Reduced traction could cause sliding. •Do not try to stabilize the machine by putting your foot on the ground. •III.

CHILDREN Tragic accidents can occur if the operator is not alert to the presence of children. Children are often attracted to the machine and the mowing activity. Never assume that children will remain where you last saw them. •NEVER allow children to operate the machine. •@@•Be alert and turn off the machine if children enter the area.

•Before and when backing, look behind and down for small children. •Never carry children. @@•Use extra care when approaching blind corners, shrubs, trees, or other objects that may obscure vision. •••••IV. SERVICE •The operation of any mower can result in foreign objects thrown into the eyes, which can result in severe eye damage.

Always wear safety glasses or eye shields while operating your mower or performing any adjustments or repairs. We recommend a wide vision safety mask over spectacles or standard safety glasses. ••Use extra care in handling gasoline and other fuels. They are flammable and vapors are explosive. Use only an approved container. Never remove gas cap or add fuel with the engine running. Allow engine to cool before refueling. Do not smoke. Never refuel the machine indoors. Never store the machine or fuel container inside where there is an open flame, such as a water heater.

Never run a machine inside a closed area. @@Never tamper with safety devices. Check their proper operation regularly. Keep machine free of grass, leaves, or other debris buildup. Clean oil or fuel spillage. Allow machine to cool before storing. Stop and inspect the equipment if you strike an object. Repair, if necessary, before restarting. Never make adjustments or repairs with the engine running. @@@Mower blades are sharp and can cut.

@@Check brake operation frequently. @@Be sure the area is clear of other people before mowing. Stop machine if anyone enters the area. Never carry passengers or children even with the blades off. Do not drive in reverse unless absolutely necessary.

Always look down and behind before and while backing. Never carry children. @@@Be alert and turn machine off if children enter the area. Before and when backing, look behind and down for small children. Mow up and down slopes (10° Max), not across.

Remove obstacles such as rocks, tree limbs, etc. Watch for holes, ruts, or bumps. Uneven terrain could overturn the machine. Tall grass can hide obstacles. Use a slow speed while on slope or hill. Avoid starting or stopping on a slope. @@@@with this mower.



[You're reading an excerpt. Click here to read official HUSQVARNA 42 user guide](http://yourpdfguides.com/dref/4735685)

<http://yourpdfguides.com/dref/4735685>

@@@It means CAUTION! BECOME ALERT! @@@@ • Place motion control levers in "NEUTRAL" position. • Turn ignition key "OFF" and remove key.
@@@@Remove the discharge chute from the deck.

(Deck configuration will vary by size and model) 2. Lower deck to the lowest cutting position. 3. Remove the right hand (discharge side) belt cover from the deck. 4. @@(See Operator's Manual if necessary) 1. Place blower assembly on secure table or stable surface. 2. Remove the bolts securing the rear mount bracket. 3.

@@4. @@@@6. Install drive pulley included Drive Pulley in collection system kit T KITS Units with two or more weight plates Units with one weight plate
1. @@2. Slide both weight brackets over the front tube on the frame.

Be sure to position in the center of the frame. 3. Secure with four (4) 2¾" bolts and four (4) nuts. 1. @@2.

Slide both weight brackets over the front tube on the frame. Be sure to position in the center of the frame. 3. Secure with four (4) 2¾" bolts and four (4) nuts.
Front Tube Weight Plates Weight Plate 2¾ Bolt 1¼ Bolt Nut Weight Bracket 1¼ Bolt Nut Weight Bracket Collection System Size 42" 2 Bin 42" 3 Bin 48" 2 Bin 48" 3 Bin 52" 2 Bin 52" 3 Bin 61" 3 Bin Number of Weights 1 3 1 3 0 2 0 CAUTION DO NOT operate mower with grass catcher, unless the front weights are installed. NOTE: The 61 deck does not require weights. 14 ASSEMBLY 13 MOUNTING COVER ASSEMBLY TO SUPPORT ASSEMBLY (2 BAG SYSTEM) 14 MOUNTING COVER ASSEMBLY TO SUPPORT ASSEMBLY (3 BAG SYSTEM) NOTE: For ease of assembly, you may wish assistance from another person for mounting the cover assembly to mower. 1. Position cover assembly on ground behind mower. 2.

Lift and rotate cover to align the cover bracket with hanger bracket and slide the cover down until secure. NOTE: For ease of assembly, you may wish assistance from another person for mounting the cover assembly to mower. 1. Position cover assembly on ground behind mower. 2. Lift and rotate cover to align the cover brackets with support assembly tubes. 3. Slide the cover down over the support tubes until secure. Cover Assembly Frame Bracket Hanger Bracket Support Assembly 15 OPERATION TIPS FOR IMPROVED BAGGING Follow the mower operation instructions in your mower operator's manual.

When operating your grass catcher on a lawn where grass and leaf bagging equipment has not been used, you are picking up thatch and debris that has accumulated for long periods of time.

The amount collected and the total time of operation may be greater than you will experience with regular use of your grass catcher. • Always run throttle at full speed when bagging. • Select a speed low enough to give good mower cutting performance, good quality cut and good bagging performance. NOTE: It may be necessary to overlap width of cut to suit your conditions. • If grass is extremely tall, it should be mowed twice.

The first time relatively high, the second time to desired height. • Use left hand side of mower for trimming. • Plastic trash bags (3.0 mil, 30 gallon) can be inserted inside grass catcher containers for ease of debris disposal. To remove the plastic trash bags when full: a.

Disengage blades, shift into neutral, engage the parking brake and stop the engine. b. Unlatch and raise cover. c. Remove one container at a time by grasping container handles and pulling toward the rear, off of the tube rails. d. With the container resting on the ground, close and secure the top of the plastic lawn bag. e. Tip the container on its side and slide the filled bag from the container. f.

Install a new plastic lawn bag with the edges of the bag draped over upper lip of the Container (for replacement bags refer to REPLACEMENT PARTS). g. Repeat for other container. h. Reinstall containers making sure right container overlaps left container at center supports. i. Close cover and secure latches over center support tubes. • Avoid cutting wet grass or in the morning while the dew is still heavy. Grass clippings collected under these conditions tend to be sticky and adhere to the walls of the flow path causing clogging. If the grass catcher fails to pick up cut grass or leaves, it is an indication that clogging has occurred in the system or that the grass catcher containers are full.

a. Disengage blades, place motion control levers in neutral position. - Unlatch and raise cover. - Slide out containers and dispose of clippings. - Replace containers, close cover, and latch.

b. Unlatch chutes and check for clogging. - Remove all debris in chute. - Reassemble and latch chutes. • CAUTION • DO NOT operate mower with grass catcher partially installed.

• Disengage blades and stop engine before leaving mower seat to empty containers, unclogging chutes, etc. • Close cover before starting. • Disengage mower blades when crossing driveways or gravel surfaces and other areas where thrown objects could be a hazard. • DO NOT attempt to vacuum cans or other potentially hazardous projectiles. 16 CUSTOMER RESPONSIBILITIES GENERAL RECOMMENDATIONS Always observe safety rules when performing any maintenance. • Before each use check for loose fasteners. • Clean unit thoroughly after each use. BLADE CARE For best results mower blades must be kept sharp. Replace bent or damaged blades. • See BLADE CARE instructions in your mower operator's manual.

STORAGE When grass catcher is to be stored for a period of time, clean it thoroughly, remove all dirt, grass, leaves, etc. Store in a clean, dry place.

CAUTION Do not leave grass in bagger containers. Empty containers after each use and before storing. Failure to do so may result in spontaneous combustion which could develop into a fire. CAUTION BEFORE PERFORMING MAINTENANCE, SERVICE OR ADJUSTMENTS: • Set parking brake. @@ • Place clutch control in "DISENGAGED" position. • Turn ignition key to "OFF" position. • Make sure blades and all moving parts have completely stopped.

@@ 17 PARTS 2 12 9 4 11 4 8 7 10 5 6 5 4 6 3 3 1 ITEM PART NO.

QTY. DESCRIPTION ITEM PART NO. QTY. DESCRIPTION 1 ..

. 539 108081 ... 1 .

.. SCREW, SPEC 10- 14 x ½ 2 ... 539 108082 ... 1 ..

. BAG DUMP INDICATOR 3 ... 539 108083 ... 2 ...

SCREW, 10- 24 x 1 /8 4 ... 539 108084 ..

. 3 ... WASHER, /16 x ¾ 5 .

.. 539 108085 ... 2 ... SPACER, SPLIT 6 ..

. 539 108086 ... 2 ... NUT, ACORN 10-24 3 1 7 ...

539 108088 ... 1 ..

. LATCH, HOOD 8 ... 539 108089 .

.. 1 ... PLATED, WELD NUT 9 ... 539 108141 ..

. 1 ... CHUTE, UPPER 10 ... 539 109552 ...

2 ... WASH 3/16 LOCK 11 ..

. 539 130294 ... 1 .
.. CHUTE, MIDDLE 12 ... 539 976952 ... 1 ..
.
. @@QTY. DESCRIPTION 1 ... 532 124670 ... 1 ..
. RETAINER SPRING 2 ... 532 127533 .
. 1 ... SCREEN, COVER 3 .
.. 539 108100 .. 1 ... GASKET, COVER 4 ...

532 130895 .. 1 ... LATCH HANDLE, COVER 5 ... 532 132796 ..
. 1 ... SPRING, COVER LT 6 .
.. 532 132983 ...
1 ... SPRING, COVER RT 7 ... 532 133235 ... 1 .

.. SPACER, COVER 8 ... 539 976977 ... 8 ..
. NUT, 10-24 HEX W/NYLOC ITEM PART NO. QTY. DESCRIPTION 9 ..
. 539 991034 ... 8 .
.. SCREW 10-24 x 5/8 WSH HD 10 .



[You're reading an excerpt. Click here to read official HUSQVARNA
42 user guide](http://yourpdfguides.com/dref/4735685)
<http://yourpdfguides.com/dref/4735685>

.. 532 414173 ... 1 ..

. STRIP, REINFORCEMENT 11 ... 532 160274 ... 1 ...
COVER, TOP 12 ... 532 174083 ..
. 3 ... CAP, PLUG TUBING END 13 .
.. 532 414172 ... 1 ... FRAME ASSEMBLY, 2-BIN 14 ..

. 532 192786 ... 1 ... PIN, HINGE PIVOT 15 ...
532 400226 ... 2 ..
. CONTAINER BAG, SOFT 19 PARTS BAG ASSEMBLY 539 131605 3 2 12 12 1 11 3 8 5 10 4 7 9 6 15 14 13 16 20 PARTS ITEM PART NO. QTY.
DESCRIPTION ITEM PART NO. QTY.
DESCRIPTION 1 ... 532 192709 ... 1 ... SCREEN, COVER 2 .

.. 532 195373 ... 1 ... COVER 3 ..
. 539 976952 ... 6 .
.. SCREW, #10-24 X 5/8 4 ...
539 108096 ... 2 ... SPRING, RETAINER 5 ... 539 108097 .

.. 4 ... PLUG, TUBING END 6 ... 539 108098 ..
. 1 ... BAGGER, FRAME 7 .
.. 532 192786 ...
2 ... PIN, HINGE 8 ... 532 192550 ... 1 .

.. GASKET, COVER 9 ... 532 400226 ... 3 ..
. CONTAINER 10 ... 532 192603 .
.. 1 ...
SEAL, COVER 11 ... 532 130895 ... 2 ... HANDLE, BAGGER COVER 12 .

.. 539 976977 ... 8 ... NUT, #10-24, CROWNLOCK 13 ..
. 539 990627 ... 2 .
.. HCS, 5/16-18 X 1¼, GR5 14 ...
539 990188 ... 4 ... WASHER, 5/16, SAE 15 ... 539 990717 .

.. 2 ... NUT, 5/16-18, NYLOC 16539 110234 .
.. 1 ...
SUPPORT, CHUTE NOT SHOWN ... 539 108447 ..
. 1 ... DECAL, CE ... 539 108163 ...

1 ... DECAL, CATCHER ... 539 131605 ... 1 ASSEMBLY (INCLUDES ITEMS 1-12) 21 PARTS 46 44 24 47 14 4 This side towards bearing 15 31 55 30 11 21
45 11 17 22 38 50 28 18 40 11 56 16 48 52 34 19 47 14 Torque to 30 LBs 26 15 60 49 42 11 33 48 41 56 40 23 11 51 12 44 10 32 25 37 7 39 45 27 36 43 6 23
60 9 13 2 59 8 3 20 5 35 29 53 10 40 12 44 51 1 22 PARTS ITEM PART NO.

QTY. DESCRIPTION ITEM PART NO. QTY. DESCRIPTION 1 ..
. 539 101977 ... 1 .
.. TRACTION SPRING 2 ... 539 976952 ... 1 ..

. SCREW 10-24 x .625 RD 3539 104411 ... 1 .
.. KNOB W/STUD 4 ...
539 104763 ... 1 ..
. RETAINER 5/16 "U" TYPE 5 ... 539 105785 ... 1 ...

EURO DECAL, WARNING 6 ... 539 106741 ... 1 ... EURO DECAL, SEVERING 7 .
.. 539 108084 ...
1 ... WASHER, /16 x ¾ x 16 GA 8 ..
. 539 108088 ... 1 ... LATCH, HOOD 9 ...

539 108089 ... 1 ... PLATED, WELD NUT 10 ... 539 108120 .
.. 2 ...
NUT ¼-20 HEX NYLOC ZD 11 ... 539 990717 ..
. 5 ... NUT /16-18 HEX NYLOC ZD 12 ... 539 108735 ...

2 ... NUT ¼-20 HEX FLANGE 13 ... 539 109552 ... 2 .
.. WASH 3/16 LOCK ZD 14 ...
539 110321 ... 2 .
.. BOLT, HEX 3/8-24 x 1¼ GR 8 15539 110323 ... 2 .

.. WASHER, HARDENED 16539 113683 ... 1 .
.. V-IDLER 17 ...

.539 115667 ... 1 .
 .. KEY, 3/16 x 1/2 18 ... 539 125229 ... 1 ..

 . KEY-SQ, 3/16 x 1 1/2 19 ... 539 130292 ... 1 ..
 . IMPELLER 20 ... 539 130293 .
 .. 1 ...
 COVER, BELT 21 ... 539 130295 ... 1 ... HUB, BEARING 22 .

 .. 539 130296 ... 2 ... BEARING 23 ..
 . 539 130301 ... 2 .
 .. BUSHING 24 ...
 539 130309 ... 1 ... COVER, OUTER PULLEY 25 ... 539 130313 .

 .. 6 ... NUT, 5/16-18 TEE 26 ... 539 130314 ..
 11 ... NUT, 1/4-20 TEE 27 ..
 . 539 130315 ... 6 .
 .. HCS 5/16-18 x 1/2 GR 5 ZD 28 ... 539 130316 ... 1 ..

 . SHAFT, IMPELLER 29 ... 539 130317 ... 1 ...
 PIN 5 3 30 ... 539 130323 ..
 . 1 ... SPACER 31 .
 .. 539 130324 ... 1 ... PULLEY 32 ..

 . 539 130335 ... 1 ... MOUNT, IDLER, UPPER 33 ...
 539 130336 ... 1 ..
 . MOUNT, IDLER, LOWER 34 ... 539 130337 .
 .. 1 ... ARM, IDLER 35 ... 539 130338 ..

 . 1 ... ARM, TENSION 36 ... 539 130339 ...
 1 ... BRKT, MT, FRONT 37 ..
 . 539 130340 ... 1 .
 .. BRKT, MT, REAR 38 ... 539 130341 ... 1 ..

 . PLATE, OUTER 39 ... 539 130346 ... 1 ...
 KEEPER 40 ... 539 200282 ..
 . 3 ... NUT, 3/8-16 HEX JAM NYLOC 41 .
 .. 539 919078 ... 1 ... IDLER PULLEY 42 ..

 . 539 976949 ... 1 ... HCS 3/8-16 x 1 1/4 GR 5 ZD 43 ...
 539 976988 ... 1 ..
 . HAIRPIN COTTER 44 ... 539 990055 .
 13 ... WASHER, 1/4 FLAT SAE ZD 45 ... 539 990302 ... 8 .

 .. SCREW, 1/4 x 3/8 THRD FRM 46 ... 539 108461 ... 3 ..
 . HCS 1/4-20 x 1/2 GR 5 ZD 47
 539 990118 ... 2 ..
 . WASHER, 3/8 SPLT LOCK ZD 48 ... 539 990122 ... 2 ...

 WASHER, 3/8 SAE FLT ZD 49 ... 539 990209 ... 1 ... HCS 5/16-18 x 1 GR 5 ZD 50 .
 .. 539 990316 ...
 4 ... RHSNB 5/16-18 x 3/4 GR5 ZD 51 ..
 . 539 990643 ... 2 ... HCS 1/4-20 x 7/8 GR 5 ZD 52 ...

 539 990655 ... 1 ... HCS 3/8-16 x 1 1/2 GR 5 ZD 53 ... 539 990692 .
 .. 1 ...
 WASHER, 5/16 STD FLT ZD 54 ... 539 130349 ..
 . 1 ... DECAL, BELT ROUTING 55 ... 539 131085 ...

 1 ... KEEPER, BELT, OUTER 56 ... 539 131087 ... 2 .
 .. KEEPER, BELT, REAR 57 ...
 539 132122 ... 1 ..
 . PLATE, BACKING 58 ... 539 132124 ... 1 ...

PLATE, BACKING 23 PARTS 8 10 1 9 12 5 7 11 6 6 1 3 6 2 6 4 14 20 19 15 22 16 18 13 12 17 12 21 16 24 PARTS ITEM PART NO. QTY. DESCRIPTION
 ITEM PART NO. QTY. DESCRIPTION 1 ... 539 130305 ...
 1 ... SHIELD, BELT, 42" 2 ..
 . 539 130306 ... 1 .

.. SHIELD, BELT, 48" 3 ... 539 130307 ... 1 ..

. SHIELD, BELT, 52" 4 ... 539 130308 ... 1 ...
 SHIELD, BELT, 61" 5 ... 539 130319 ..
 . 1 ... PULLEY, 42/48" .
 .. 539 130320 ... 1 ... PULLEY, 52" ..

. 539 130321 ... 1 ... PULLEY, 61" 6 ...
 539 105743 ... 1 ..

. DECAL, EURO NO STEP 7 ... 539 130342 .
 .. 1 ... PLATE, MOUNT 8 ... 539 130334 ..

. 1 ... BELT, 42" ... 539 130347 ...
 1 ... BELT, 48/52" ..
 . 539 130348 ... 1 .
 .. BELT, 61" 9 ... 539 130343 ... 1 ..

. PLATE, BACKING 10 ... 539 990316 ... 3 ...
 RHSNB 5/16-18 x 3/4 11 ... 539 990208 ..
 . 4 ... RRSNB 5/16-18 x 1 12 .
 .. 539 990717 . 13 ... NUT, 5/16-18 HEX NYLOC 13 ... 539 131091 .

. 1 .. TUBE, MOUNT 14 ... 539 976937 .. 2 ..
 HCS 5/16-18 X 2 GR 5 ZD 15 ... 539 976938 ..
 4 .. HCS 5/16-18 X 2 1/4 GR 5 ZD 16 ...
 539 990692 16 .. WASHER, 5/16 STD FLT ZD 17 ... 539 990627 .. 4 .. HCS 5/16-18 X 1 1/4 GR 5 ZD 18 .

.. 539 990188 .. 4 .. WASH 5/16 SAE FLAT ZD 19
 539 110234 .. 1 .. SUPPOT, HOSE 20 .
 ...539 112294 ..
 1 .. FLEX TRIM, BLACK 21 ... 539 131089 .. 1 .. STRAP, RT 22 .

.. 539 131090 .. 1 .. STRAP, LT 25 PARTS WEIGHT KIT 42/48" 4 3 2 BIN PART NO. QTY. DESCRIPTION ITEM 1 ..
 ..539 113232 ...
 1 ... WEIGHT PLATE 2 ..
 ..539 113203 ... 2 ... WEIGHT BRACKET 3 ..

. 539 976979 ... 8 ... NUT 3/8-16 HEX NYLOC ZD 4 ...
 539 102612 ... 4 ..
 . HCS 3/8-16 x 2 3/4 GR 5 ZD 5 ... 539 976941 .
 .. 4 ... HCS 3/8-16 x 1 1/4 GR 5 ZD 2 1 5 WEIGHT KIT 42/48" 4 3 BIN PART NO. QTY. DESCRIPTION ITEM 3 1 ...

.539 113232 ... 3 ... WEIGHT PLATE 2 ...
 .539 113203 ... 2 .
 .. WEIGHT BRACKET 3 ...
 539 976979 ... 8 ... NUT 3/8-16 HEX NYLOC ZD 4 ... 539 102612 .

.. 4 ... HCS 3/8-16 x 2 3/4 GR 5 ZD 5 ... 539 976949 ..
 . 4 ... HCS 3/8-16 x 1 3/4 GR 5 ZD 2 1 5 WEIGHT KIT 52" 3 4 3 BIN PART NO.
 QTY. DESCRIPTION ITEM 1
 539 113232 ... 2 ... WEIGHT PLATE 2

539 113203 ... 2 ... WEIGHT BRACKET 2 1 3 ... 539 976979 .
 .. 8 ...
 NUT 3/8-16 HEX NYLOC ZD 4 ... 539 102612 ..
 . 4 ... HCS 3/8-16 x 2 3/4 GR 5 ZD 5 ... 539 976949 ...

4 ... HCS 3/8-16 x 1 3/4 GR 5 ZD 5 26 539 130330 R3 01/22/08 .



[You're reading an excerpt. Click here to read official HUSQVARNA 42 user guide](http://yourpdfguides.com/dref/4735685)
<http://yourpdfguides.com/dref/4735685>