



Your PDF Guides

You can read the recommendations in the user guide, the technical guide or the installation guide for HONEYWELL HCW 23. You'll find the answers to all your questions on the HONEYWELL HCW 23 in the user manual (information, specifications, safety advice, size, accessories, etc.). Detailed instructions for use are in the User's Guide.

User manual HONEYWELL HCW 23
User guide HONEYWELL HCW 23
Operating instructions HONEYWELL HCW 23
Instructions for use HONEYWELL HCW 23
Instruction manual HONEYWELL HCW 23

Honeywell

Hometronic
Installation instructions
HCW 23 remote regulator

1. Remove the housing cover from the remote regulator.

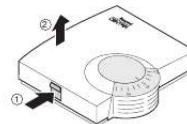

Fig. 1: Removing the housing cover

2. Lift off the regulator wheel.
3. Screw the remote regulator onto the flush-mounting socket.

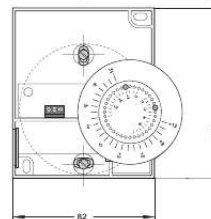

Fig. 2: Flush-mounting socket mounting and position of the regulator wheel

4. Connect the cable coming from the unit controller.

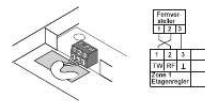

Fig. 3: Connecting the cable from the unit controller



[You're reading an excerpt. Click here to read official HONEYWELL HCW 23 user guide](http://yourpdfguides.com/dref/2939084)
<http://yourpdfguides.com/dref/2939084>

