



# Your PDF Guides

You can read the recommendations in the user guide, the technical guide or the installation guide for BOSCH AKE 35 S. You'll find the answers to all your questions on the BOSCH AKE 35 S in the user manual (information, specifications, safety advice, size, accessories, etc.). Detailed instructions for use are in the User's Guide.

User manual BOSCH AKE 35 S  
User guide BOSCH AKE 35 S  
Operating instructions BOSCH AKE 35 S  
Instructions for use BOSCH AKE 35 S  
Instruction manual BOSCH AKE 35 S

Originalbetriebsanleitung  
Original instructions  
Notice originale  
Manual original  
Manual original  
Istruzioni originali  
Oorspronkelijke  
gebruiksaanwijzing  
Original brugsanvisning  
Bruksanvisning i original  
Original driftsinstruks  
Alkuperäiset ohjeet  
Πρωτότυπο οδηγίων  
χρήσης  
Oriġinal iġletme talimat

Deutsch  
English  
Français  
Español  
Português  
Italiano  
Nederlands  
Dansk  
Svenska  
Norsk  
Suomi  
Ελληνικά  
Türkçe



**AKE 30 S**  
**AKE 35 S**  
**AKE 40 S**

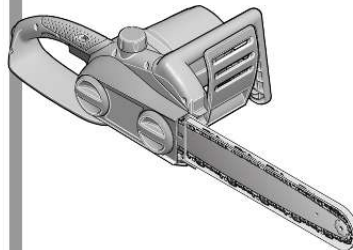

[You're reading an excerpt. Click here to read official BOSCH AKE 35 S user guide](http://yourpdfguides.com/dref/2286577)  
<http://yourpdfguides.com/dref/2286577>

**Manual abstract:**

@@Save all warnings and instructions for future reference. @@@@Remove the plug from the socket or mains immediately before carrying out any adjustments, servicing or maintenance or if the cable is damaged or cut. Obtain and wear eye and ear protection at all times while operating the power tool. The kick back brake and the run down brake stop the chain saw within short time. Work area Keep work area clean and well lit. cluttered and dark areas invite accidents. Do not operate power tools in explosive atmospheres, such as in the presence of flammable liquids, gases or dust. Power tools create sparks which may ignite the dust or fumes. This appliance is not intended for used by persons (including children) with reduced physical, sensory or mental capabilities, or lack of experience and knowledge, unless they have been given supervision or instruction concerning use of the appliance by a person responsible for their safety. Children should be supervised to ensure that they do not play with the appliance.

Keep children and bystanders away while operating a power tool. Distractions can cause you to lose control. Children and juveniles, except above age 16, under supervision and for educational purposes, must not operate the chain saw, nor should persons unfamiliar with the saw or its handling (when borrowing). ensure operation manual is with the saw. Persons unfit or tired must not operate the chain saw.

Electrical safety Power tool plugs must match the outlet. Never modify the plug in any way. Do not use any adapter plugs with earthed (grounded) power tools. unmodified plugs and matching outlets will reduce risk of electric shock. Avoid body contact with earthed or grounded surfaces, such as pipes, radiators, ranges and refrigerators.

There is an increased risk of electric shock if your body is earthed or grounded. Do not expose power tools to rain or wet conditions. Water entering a power tool will increase the risk of electric shock. do not abuse the cord. Never use the cord for carrying, pulling or unplugging the power tool. Keep cord away from heat, oil, sharp edges or moving parts. damaged or entangled cords increase the risk of electric shock. When operating a power tool outdoors, use an extension cord suitable for outdoor use. Use of a cord suitable for outdoor use reduces the risk of electric shock. If operating a power tool in a damp location is unavoidable, use a residual current device (RCD) protected supply.

Use of an RCD reduces the risk of electric shock. Personal safety Stay alert, watch what you are doing and use common sense when operating a power tool. Do not use a power tool while you are tired or under the influence of drugs, alcohol or medication. A moment of inattention while operating power tools may result in serious personal injury. use safety equipment. Always wear eye protection. Safety equipment such as dust masks, non-skid safety shoes, hard hat, or hearing protection used for appropriate conditions will reduce personal injuries. avoid accidental starting. Ensure the switch is in the off position before plugging in. Carrying power tools with your finger on the switch or plugging in power tools that have the switch on invites accidents.

Remove any adjusting key or wrench before turning the power tool on. A wrench or a key left attached to a rotating part of the power tool may result in personal injury. This enables better control of the power tool in unexpected situations. dress properly. Do not wear loose clothing or jewellery.

Keep your hair, clothing and gloves away from moving parts. Loose clothes, jewellery or long hair can be caught in moving parts. If devices are provided for the connection of dust extraction and collection facilities, ensure these are connected and properly used. Use of these devices can reduce dust related hazards.

Power tool use and care Do not force the power tool.

Use the correct power tool for your application. The correct power tool will do the job better and safer at the rate for which it was designed. Do not use the power tool if the switch does not turn it on and off. Any power tool that cannot be controlled with the switch is dangerous and must be repaired. Disconnect the plug from the power source before making any adjustments, changing accessories, or storing power tools. Such preventive safety measures reduce the risk of starting the power tool accidentally. Store idle power tools out of the reach of children and do not allow persons unfamiliar with the power tool or these instructions to operate the power tool. Power tools are dangerous in the hands of untrained users. maintain power tools. Check for misalignment or binding of moving parts, breakage of parts and any other condition that may affect the power tool's operation.

If damaged, have the power tool repaired before use. Many accidents are caused by poorly maintained power tools. keep cutting tools sharp and clean. Properly maintained cutting tools with sharp cutting edges are less likely to bind and are easier to control. Use the power tool, accessories and tool bits etc. , in accordance with these instructions and in the manner intended for the particular type of power tool, taking into account the working conditions and the work to be performed. Use of the power tool for operations different from those intended could result in a hazardous situation. Service Have your power tool serviced by a qualified repair person using only identical replacement parts. This will ensure that the safety of the power tool is maintained. Chain Saw Safety

Warnings: Keep all parts of the body away from the saw chain when the motor is operating.

Before you start the saw, make sure the saw chain is not contacting anything. A moment of inattention while operating chain saws may cause entanglement of your clothing or body with the saw chain. Always hold the chain saw with your right hand on the rear handle and your left hand on the front handle. Holding the chain saw with a reserved hand configuration increases the risk of personal injury and should never be done. Wear safety glasses and hearing protection.

Further protective equipment for head, hand, legs and feet is recommend. Adequate protective clothing will reduce personal injury by flying debris or accidental contact with saw chain. Do not operate a chain saw in a tree. Operation of a chain saw in a tree, may result in personal injury. Always keep proper footing and operate the chain saw only when standing on fixed, secure and level surface.

When the tension in the wood fibres is released the spring loaded limb may strike the operator and/or throw the chain saw out of control. Use extreme caution when cutting brush and saplings. The slender material may catch the saw chain and be whipped toward you or pull you off balance. Carry the chain saw by the front handle with the saw chain stopped and the guide bar pointing to the rear. When transporting or storing the chain saw always fit the guide bar cover.

Proper handling of the chain saw will reduce the likelihood of accidental contact with the moving saw chain.



[You're reading an excerpt. Click here to read official BOSCH AKE 35](#)

[S user guide](#)

<http://yourpdfguides.com/dref/2286577>

follow instructions for lubricating , chain tensioning and changing accessories. Improperly tensioned or lubricated chain may either break or increase the chance for kickback. Keep handles dry, clean, and free from oil and grease. Don't use chain saw for purposes not intended for example Don't use chain saw for cutting plastic, masonry or nonwood building materials.

Use of the chain saw for operations different than intended could result in a hazardous situation. Causes and Operator Prevention of Kickback: Kickback may occur when the nose or tip of the guide bar touches an object, or when the wood closes in and pinches the saw chain in the cut. Tip contact in some cases may cause a sudden reverse reaction, kicking the guide bar up and back towards the operator. Pinching the saw chain along the top of the guide bar may push the guide bar rapidly back towards the operator. Either of these reactions may cause you to lose control of the saw which could result in serious personal injury. Do not rely exclusively upon the safety devices built into your saw. As a chain saw user, you should take several steps to keep your cutting jobs free from accident or injury. Kickback is the result of tool misuse and/or incorrect operating procedures or conditions and can be avoided by taking proper precautions as given below: Maintain a firm grip, with thumbs and fingers encircling the chain saw handles, with both hands on the saw and position your body and arm to allow you to resist kickback forces. Kickback forces can be controlled by the operator, if proper precautions are taken. do not let go of the chain saw.

Do not over reach and do not cut above shoulder height. This helps prevent unintended tip contact and enables better control of the chain saw in unexpected situations. Follow the manufacturer's sharpening and maintenance instructions for the saw chain. Chain saw Part number (typ) Rated power Chain speed (no load) Chain bar length Tool-less chain tensioning (SDS) Nose sprocket Kickback Brake Chain type Drive link thickness Amount of drive links Oil reservoir capacity Automatic oiler Metal gripping teeth Weight without mains cable. \*\*measured with chain bar and chain Note: Please observe the order number of your machine.

The trade names of individual machines can vary. inrush currents cause short-time voltage drops. Under unfavourable power supply conditions, other equipment may be affected. If the system impedance of the power supply is lower than 0. The chain saw is intended for sawing of trees, tree trunks, branches, wooden beams, planks, etc.

Cuts can be sawed with or across the grain. This product is not suitable for sawing mineral materials. This manual gives instructions on the correct assembly and safe use of your chain saw. It is important that you read these instructions carefully. Carefully remove the machine from its packaging and check for complete contents: Chain saw Cover plate Chain Chain bar Chain guard Operating instructions When parts are missing or damaged, please contact your dealer. Switch off, remove plug from mains before adjusting cleaning or if the cable is cut, damaged or entangled. Do not operate chain saw near other people, children or animals. Do not operate chain saw after drinking alcohol or under the influence of intoxicating drugs or medication. Electrical Safety Your machine is double insulated for safety and requires no earth connection. Extension cords/leads should only be used if they comply with H07-F types or IEC (60227 IEC 53).

@@@Always check your RCD every time you use it. @@@@Fixing means for the connection leads must be used. @@@@1 2 3 4 5 6 7 8 9 10 11 12 13 14 15 16 17 18 19 20 21 22 23 Rear handle On/Off switch Safety lock Oil filler cap Activation lever for kickback brake (hand guard) Front handle Nose sprocket (AKE 35/anders. @@ to avoid kickback: Saw with the chain bar at a flat angle. @@ Always the hold chain saw firmly with both hands.

General Behavior D Always hold the chain saw firmly with both hands. Front grip with the left hand and rear grip with the right hand. Fully grip both handles at all times during operation. Never operate chain saw using only one hand. @@E Use the chain saw only with secure footing. Hold the chain saw at the right-hand side of your body. @@@@Do not remove the saw completely from the wood. @@@@Never use the chain saw above shoulder height. @@ beware when reaching the end of the cut. @@Accidents can occur to the legs and feet.

Always remove the saw from a wood cut while the saw is running. @@ chain stops immediately. @@Push front hand guard 5 forward (position ) and start the chain saw. the chain must not start. To deactivate the kickback brake, release On/Off switch 2 and pull hand guard 5 backwards (position ). Before Cutting Before and periodically during cutting check as follows: B Is the oil reservoir filled? Check oil level gauge 25 prior to starting and regularly during operation. Refill oil when oil level is low. Check chain tension every 10 minutes during operation. Upon initial operation, new chains can lengthen considerably. the condition of the chain influences the the cutting performance. Only a sharp chain protects from overload. Is the kickback brake deactivated and its function ensured? Are you wearing the necessary protective equipment? Wear safety glasses and hearing protection. Further protective equipment for head, hand, legs and feet is recommend. Adequate protective clothing will reduce personal injury by flying debris or accidental contact with saw chain. D Kickback Kickback is the sudden backward/upward motion of the chain saw, occurring when the chain (at the tip of the chain bar) comes in contact with a log or wood, or when the chain becomes jammed.

Cutting Logs Observe the following safety instructions: E H Support logs so that the face sides at the cut do not close in against each other, which would result in the chain being jammed or pinched. When sawing, always take care to avoid hitting stones, nails, etc. , as these could be thrown up or cause damage to the chain or serious injury to the operator or bystanders. Keep a running saw clear of wire fencing or the ground. Use of the saw to thin out branches or bushes is not approved. Length cuts must be carried out with care, as leverage with the gripping teeth 11 is not possible. saw at a flat angle to avoid kickback. When working on a slope, operate above or to the side of the trunk or laying tree. Be careful not to trip over tree stumps, branches, roots, etc. H Cutting Wood under Tension There is a high risk of accidents when sawing wood, branch or trees under tension. be extremely careful. Leave saw jobs like these to professionals. When sawing logs supported on both ends, start the cut from above (Y) about 1/3 of the diameter into the log and then finish the cut (Z) from below, in order to avoid splitting of the log or jamming of the saw.



[You're reading an excerpt. Click here to read official BOSCH AKE 35](http://yourpdfguides.com/dref/2286577)

[S user guide](http://yourpdfguides.com/dref/2286577)

<http://yourpdfguides.com/dref/2286577>

avoid contact of the chain saw with the ground. When sawing logs supported on only one end, start the cut from below (Y) about 1/3 of the diameter into the log and finish the cut from above (Z), in order to avoid log splitting or jamming of the chain saw.

The chain saw operator should keep on the uphill side of the terrain as the tree is likely to roll or slide downhill after it is felled. An escape path should be planned and cleared as necessary before cuts are started. The escape path should extend back and diagonally to the rear of the expected line of fall. Before felling is started, consider the natural lean of the tree, the location of larger branches and the wind direction to judge which way the tree will fall. Remove dirt, stones, loose bark, nails, staples, and wire from the tree.

**Notching Undercut:** Make the notch (X W) 1/3 the diameter of the tree, perpendicular to the direction of falls as Make the lower horizontal notching cut first. This will help to avoid pinching either the saw chain or the guide bar when the second notch is being made. **Felling Back Cut:** Make the felling back cut (Y) at least 50 mm higher than the horizontal notching cut. Keep the felling back cut parallel to the horizontal notching cut. Make the felling back cut so enough wood is left to act as a hinge. The hinge wood keeps the tree from twisting and falling in the wrong direction. Do not cut through the hinge. As the felling gets close to the hinge the tree should begin to fall. If there is any chance that the tree may not fall in desired direction or it may rock back and bind the saw chain, stop cutting before the felling back cut is complete and use wedges of wood, plastic or aluminium to open the cut and drop the tree along the desired line of fall. When the tree begins to fall remove the chain saw from the cut, stop the motor, put the chain saw down, then use the retreat path planned.

Be alert for overhead limbs falling and watch your footing. To complete the felling operation, drive a wedge (Z) into the horizontal cut. Beware of falling branches when the tree starts to move. **Limbing a Tree K Limbing** is removing the branches from a fallen tree. When limbing leave larger lower limbs to support the log off the ground. Remove the small limbs in one cut as illustrated. Branches under tension should be cut from the bottom up to avoid binding the chain saw. Always wear hard hat to protect head against falling branches. The chain saw can only be used to fell trees smaller in diameter than the length of the chain bar. secure work area.

Ensure no persons or animals are in the vicinity of the falling tree. Never attempt to free a jammed saw with the motor running. Use wooden wedges to free chain and chain bar. When cutting and felling operations are being performed by two or more persons, at the same time, the felling operations should be separated from the cutting operation by a distance of at least twice the height of the tree being felled. Trees should not be felled in a manner that would endanger any person, strike any utility line or cause any property damage.

If the tree does make contact with any utility line, the company should be notified immediately. It is important to make sure your footing is firm and your weight is evenly distributed on both feet. When possible, the log should be raised and supported by the use of limbs, logs or chocks. Follow the simple directions for easy cutting. When the log is supported along its entire length as illustrated, it is cut from the top (overbuck).

**M** When the log is supported on one end, as illustrated, cut 1/3 the diameter from the underside (underbuck). Then make the finished cut by overbucking to meet the first cut. **N** When the log is supported on both ends, as illustrated, cut 1/3 the diameter from the top overbuck. Then make the finished cut by underbucking the lower 2/3 to meet the first cut. **o** When bucking on a slope always stand on the uphill side of the log, as illustrated. When "cutting through", to maintain complete control release the cutting pressure near the end of the cut without relaxing your grip on the chain saw handles. don't let the chain contact the ground. After completing the cut, wait for the saw chain to stop before you move the chain saw. Always stop the motor before moving from tree to tree. The circular groove of the chain bar will wear particularly on the lower edge with time.

When replacing the chain turn the chain bar 180° to allow even wear, thus extending chain bar life. Have your chain sharpened professionally at your Bosch approved service agent or sharpen the chain yourself using the Bosch sharpening kit or a Dremel power tool with the appropriate grinder (1453), both available at your Bosch approved service agent. Follow the sharpening instructions supplied with the sharpening kit. Proper functioning of the automatic oiler can be checked by running the chain saw and pointing the tip of the chain bar towards a piece of cardboard or paper on the ground. Caution: Do not touch the ground with the chain. If there is no oil pattern, despite a full oil reservoir, see "Fault Finding" or contact your Bosch approved service agent.

Before any work on the machine itself, pull the mains plug from the socket. @@@@ check that covers and guards are undamaged and correctly fitted. @@@@Before returning, ensure all oil in the oil tank has been emptied. For all correspondence and spare parts orders, always include the 10-digit part number (TYP) from the nameplate of the machine! Clean the moulded plastic housing of the chain saw using a soft brush and clean cloth.

Remove and brush clean the cover plate 13, chain and chain bar after 1 to 3 hours of use. Clean the area under the cover plate 13, the drive sprocket 20 and chain bar assembly using a soft brush. Clean oil outlet 18 with a clean cloth. If the chain saw is to be stored for a longer period of time, clean chain and chain bar. Store in a secure, dry place out of the reach of children.

Do not place other objects on the chain saw. to prevent leakage ensure machine is left in a horizontal position (oil filler cap 4 uppermost). When storing machine in original packaging the oil tank must be completely emptied. The following table gives checks and actions that you can perform if your machine does not operate correctly. If these do not identify/remedy the problem, contact your service agent.

**Warning:** Switch off and remove plug from mains before investigating fault. Symptom Chain saw fails to operate Possible Cause Kickback brake is activated No power Mains socket faulty Extension cord damaged Fuse faulty Chain saw operates intermittently Extension cord damaged Loose connection Internal wiring defective On/Off switch defective No oil in reservoir Vent in oil filler cap clogged Oil passage clogged Brake does not stop chain No oil in reservoir Vent in oil filler cap clogged Oil passage clogged Chain is over tensioned Dull chain Chain tension too loose Dull chain Chain worn out Chain teeth are facing in the wrong direction Remedy Pull hand guard 5 back in position (Figure D) Check power Use another socket Check cord, replace Replace fuse Check cord, replace Contact service agent Contact service agent Contact service agent Refill oil Clean cap Clean oil passage outlet Contact service agent Refill oil Clean cap Clean oil passage outlet Adjust chain tension Sharpen chain or replace Adjust chain tension Sharpen chain or replace Replace chain Reassemble with chain in correct direction Chain saw rips, vibrates, does not saw properly Power tools, accessories and packaging should be sorted for environmental-friendly recycling.



[You're reading an excerpt. Click here to read official BOSCH AKE 35 S user guide](http://yourpdfguides.com/dref/2286577)  
<http://yourpdfguides.com/dref/2286577>

*Only for EC countries: Do not dispose of power tools into household waste! According to the European Directive 2002/96/EC on waste electrical and electronic equipment and its incorporation into national law, products that are no longer suitable for use must be separately collected and sent for recovery in an environmentally-friendly manner. Our after-sales service responds to your questions concerning maintenance and repair of your product as well as spare parts. Exploded views and information on spare parts can also be found under: [www.bosch-pt.com](http://www.bosch-pt.com). Our customer consultants answer your questions concerning best buy, application and adjustment of products and accessories. Typically the A-weighted noise levels of the product are: Sound pressure level 87 dB(A); Guaranteed sound power level lower than 101 dB(A). We declare under our sole responsibility that the product described under "Technical data" is in conformity with the following standards or standardization documents: EN 60745 according to the provisions of the directives 2004/108/EC, 98/37/EC (until 28 Dec 2009), 2006/42/EC (from 29 Dec 2009), 2000/14/EC. Nenhum óleo no tanque Encher com óleo A evacuação de ar no fecho do tanque Limpar o fecho do tanque de óleo de óleo está entupido O canal de escape de óleo está obstruído Desobstruir o canal de escape de óleo A corrente não é travada*  
*Dirija-se a uma oficina especializada Bosch Andra reservsvård och sågkedjor kan leda till att kedjan brister eller till bakslag.*

*Hänvisning till produkter som inte saluförs i Storbritannien: OBS: För din säkerhet är det viktigt att på maskinen monterad kontakt 22 ansluts till skarvsladden 24, som bilden visar. .*



[You're reading an excerpt. Click here to read official BOSCH AKE 35 S user guide](#)  
<http://yourpdfguides.com/dref/2286577>