



Your PDF Guides

You can read the recommendations in the user guide, the technical guide or the installation guide for AYP YC125H42C. You'll find the answers to all your questions on the AYP YC125H42C in the user manual (information, specifications, safety advice, size, accessories, etc.). Detailed instructions for use are in the User's Guide.

User manual AYP YC125H42C
User guide AYP YC125H42C
Operating instructions AYP YC125H42C
Instructions for use AYP YC125H42C
Instruction manual AYP YC125H42C

YC125H42C (1995)
CHASSIS ENCLOSURES

Page 1 of 24

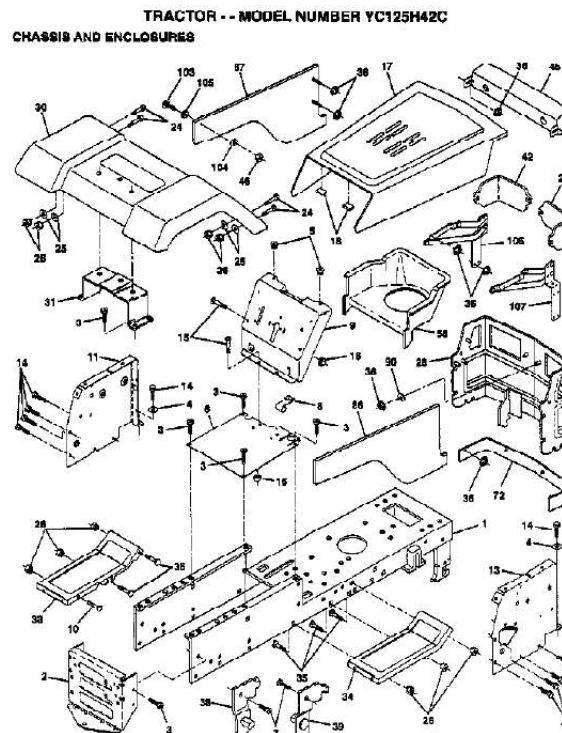

[You're reading an excerpt. Click here to read official AYP YC125H42C user guide](http://yourpdfguides.com/dref/441346)
<http://yourpdfguides.com/dref/441346>

Manual abstract:

SUB= 532126938 BOLT WASHER NUT SUB= 532128313 LENS RH LT FENDER PNT LT BRKT FENDER FOOTREST.LH.LT/GT FOOTREST.RH.LT/GT BOLT PAL NUT LT BRACKET ASM LH BRACKET ASM RH LENS LH LT SUB= 918132257 RETAINER "DUCT, INTAKE T" STRAP ASM GRILL SIDE PANEL ASM RH SIDE PANEL ASM LH WASHER PM "SCREW,SPECIAL" WASHER "GROMMET,PLASTIC" "HINGE,HOOD,LH T" "HINGE,HOOD,RH T" PLUG BUTTON T Page 2 of 24 YC125H42C (1995) DECALS Page 3 of 24 YC125H42C (1995) DECALS Ref# 1 2 3 4 5 6 7 8 9 10 11 12 14 15 16 17 19 Part Number 138956 123689X 124151X 124152X 138448 133795 101892X 105807X 142337 133671 137259 139141 145005 136832 135013 142341 140837 138311 145278 145430 LBD48 LSB42 C42 LC05 CH11 Qty Description DECAL.DASH.INSTR. @@@@NUT SPRING ROD LT WASHER COTTER PIN ROD.BRAKE.PARK.

LT PLUNGER CAP T TRANSAXLE MTG BKT "KEEPER,BELT LH T" BOLT SHAFT.PEDAL.FOOT NYLON BEARING WASHER LT SUB= 2882J PULLEY.IDLER.FLAT BOLT SPACER T BELT KEEPER LT WASHER "LY, BEARING" WASHER LT KLIP RING SUB= 139245 ARM IDLER RETAIN BELT SUB= 74930624 SUB= 73690600 SUB= 73690500 "LINK, CLUTCH T" "SPRING, RETURN LT" SUB= 74780620 BELT-V. HYDR.84.61 KEEPER BELT CNTSP SCREW PEDAL COVER T PULLEY.ENGINE BOLT LOCKWASHER KEEPER.BELT. ENG.L SCREW HEXWSH H-L KEEPER BELT ENG STRAP.TORQ.LH.HYD WASHER STRAP.TORQ.RH.HYD SPACER SPLIT WASHER E-RING LT SQUARE KEY Page 6 of 24 YC125H42C (1995) DRIVE Ref# 78 81 82 83 84 86 87 88 89 91 92 93 94 95 96 97 98 100 103 104 105 106 108 109 Part Number 121748X 141420 123782X 19171216 141423 71208 19212016 12000008 139988 74780536 74780524 142564 140462 144643 4497H 144201 73510600 19111216 73940800 141421 71070516 74780520 17541026 145098 Qty Description WASHER SHAFT.CROSS.HYD "SPRING,TORSION" WASHER ROD.

TIE.BALL.HYD. @@@@ARM SUSP REAR RETAINER.SPRING BEARING PVT LH NUT.CROWNLOCK.3/8 Page 16 of 24 YC125H42C (1995) SEAT Page 17 of 24 YC125H42C (1995) SEAT Ref# 1 2 3 4 5 6 7 8 9 10 12 13 14 15 16 17 21 22 23 24 25 26 Part Number 127427 140551 74760616 19131610 145006 73800600 124181X 17490616 19131614 140552 121246X 121248X 72050411 134300 121250X 123976X 139888 73800500 74780814 19171912 127018X 10040800 Qty Description SUB= 140119 BRACKET PVT SEAT BOLT WASHER PM CLIP.PUSH-IN.HING NUT SPRING COMPRESSIO SCREW GTV WASHER SUB= 155925 BRKT SWITCH BUSHING SUB= 872050411 SPLIT SPACER SPRING SUB= 73900400 BOLT.SHLD. 5/16-18 NUT BOLT WASHER "BOLT,SHOULDER" LOCKWASHER Page 18 of 24 YC125H42C (1995) STEERING Page 19 of 24 YC125H42C (1995) STEERING Ref# 1 2 3 4 5 6 7 8 9 10 11 12 13 14 15 16 17 18 19 20 21 22 23 24 25 26 27 28 29 30 32 36 37 38 39 40 41 42 43 46 47 Part Number 121472X 142033 135527 135228 6266H 121748X 19272016 12000029 3366R 130468 10040600 73610600 110438X 74011056 73901000 132624 132614 57079 124035X 126684X 10040400 71070410 127501 109816X 124036X 126847X 136874 19131416 17490612 76020412 130465 132196 17431008 121584X 19133808 7810H 104820X 124418X 121749X 121232X 6855M Qty Description SUB= 150546 AXLE ASM FRONT PARTS MANUAL SPINDLE RH WASHER .T WASHER WASHER RING COL. SRTG. BEAR. @@RING. RET.2003052. BEARING.(50552)42X68X16 CRADLE- 2003023. BEARING. 2003044. SWASHPLT.2003087. BLOCK.CLYN.70079. ARM.TRUN.2003005. SEAL.

9008000-0126 GUIDE.2000015. @@BOLT #8-32 X .875 SPRING.HYD.50277 STUD.5/16-24.DANA SPRING.2003014. @@TUBE Page 24 of 24 .



[You're reading an excerpt. Click here to read official AYP YC125H42C user guide](http://yourpdfguides.com/dref/441346)
<http://yourpdfguides.com/dref/441346>