



# Your PDF Guides

You can read the recommendations in the user guide, the technical guide or the installation guide for AYP RT150FR. You'll find the answers to all your questions on the AYP RT150FR in the user manual (information, specifications, safety advice, size, accessories, etc.). Detailed instructions for use are in the User's Guide.

**User manual AYP RT150FR**  
**User guide AYP RT150FR**  
**Operating instructions AYP RT150FR**  
**Instructions for use AYP RT150FR**  
**Instruction manual AYP RT150FR**

RT150FR (1999 & Before)  
MAIN FRAME, BELT, WHEELS

Page 1 of 9

**ROPER REAR TINE TILLER- MODEL NUMBERS RT150FR AND RT150ET**  
**MAIN FRAME**

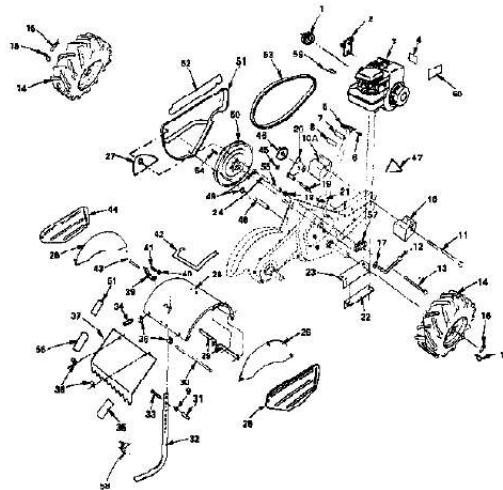

[You're reading an excerpt. Click here to read official AYP RT150FR user guide](#)

<http://yourpdfguides.com/dref/440328>

**Manual abstract:**

HEX.3/8-16UNC COUNTERWEIGHT CRT COUNTERWEIGHT CRT BOLT CRT LEVER LOCK CRT BOLT-HEX TI SUB= 124258X TIRE.CHV.13X5.0-6 SUB= 65139 RETAINER M SUB= 126875X WASHER CRT NUT.HEX.5/16-18 SHIFT ARM CRT SUB= 918105611X CONDIUT CLIP T BRACKET RH CRT BRACKET LH CRT SPACER CRT SUB= 104101X505 SHIELD CRT SUB= 110653X SUB= 102326X505 SUB= 124343X SUB= 120588X GRIP CRT SUB= 102156X500 BOLT VINYL CAP TI SUB= 120075X HINGE CRT SUB= 102695X505 SUB= 121858X DECAL TI LATCH BRACKET TI KLIP RING TI SPRING TI DECAL - TINE SHIELD STAKE PIN TI SHIELD.SD.OUT.LH KLIP RING PULLEY-IDLER TI DECAL - OPEI SPACER CRT WASHER "SHEAVE 10"" CRT" SUB= 131159X505 NLA SUB= 132672 Page 2 of 9 RT150FR (1999 & Before) MAIN FRAME, BELT, WHEELS Ref # 54 55 56 57 58 61 Part Number 2649M 110651X 104949X 109299X 109230X 109227X Qty Description KEY T SPACER CRT DECAL - DEPTH ADJUSTMENT LOCK - HANDLE SPRING CRT PAD IDLER TI Page 3 of 9 RT150FR (1999 & Before) MAIN FRAME, NUTS, BOLTS Page 4 of 9 RT150FR (1999 & Before) MAIN FRAME, NUTS, BOLTS Ref # 1 3 4 5 6 7 8 9 10 11 12 13 16 17 18 19 Part Number 23230506 19111116 104214X 72140404 10040400 73220400 74760524 10040500 73220500 74760616 10040600 73220600 98000129 72140505 72110508 72140506 Qty Description SET SCREW WASHER NUT TI BOLT LOCKWASHER SUB= 50675 BOLT.

HEX.5/16-1.5 LOCKWASHER NUT.HEX.5/16-18 BOLT LOCKWASHER NUT.

HEX.3/8-16UNC NUT BOLT BOLT CRT BOLT Page 5 of 9 RT150FR (1999 & Before) MAIN FRAME, NUTS, BOLTS Page 6 of 9 RT150FR (1999 & Before) MAIN FRAME, NUTS, BOLTS Ref # 2 6 7 12 13 14 15 20 22 Part Number 72040410 10040400 73220400 10040600 73220600 5394H 86777 72110404 72110608 Qty Description BOLT LOCKWASHER SUB= 50675 LOCKWASHER NUT.HEX.3/8-16UNC SUB= 73930600 SUB= 750097 BOLT BOLT D Page 7 of 9 RT150FR (1999 & Before) TRANSMISSION P/N BREAKOUT Page 8 of 9 RT150FR (1999 & Before) TRANSMISSION P/N BREAKOUT Ref # Part Number 109203X 1 106549X 2 102136X 3 12000039 4 8353J 5 100371K 6 7392M 7 102109X 8 104159X 9 102128X 10 102100X 11 102101X 12 106390X 13 109204X 14 4358J 15 102112X 16 106388X 17 102106X 18 102134X 19 102121X 20 4895H 21 8358J 22 1370H 23 102110X 24 4220R 25 105346X 26 102113X 27 105345X 28 5020J 29 6803J 30 4422J 31 102115X 32 106142X 33 102111X 34 12000040 36 106144X 37 106141X 38 106143X 39 102144X 40 102107X 41 10040700 42 73610700 43 109297X 44 106211X 45 73220500 46 102114X 47 106147X 48 17580408 49 9674R 50 9676R 51 9672R 52 106160X 53 106212X 54 17580410 6066J Qty Description SUB= 155112 SUB= 150698 WASHER SEAL CRT KLIP RING SHIFT FORK TI SPRING-SHIFT CRT SUB= 100482K SHAFT SHIFT CRT SPACER SPLIT CRT O RING CRT "CRT, BEARING" SCRW WHIZ LOK CRT BUSHING TI SUB= 150737 WASHER SHFT 2ND RED. @@O-RING TI BLOCK TI SCREW TI GREASE PREMIUM-1 Page 9 of 9 .



[You're reading an excerpt. Click here to read official AYP RT150FR user guide](http://yourpdfguides.com/dref/440328)  
<http://yourpdfguides.com/dref/440328>