

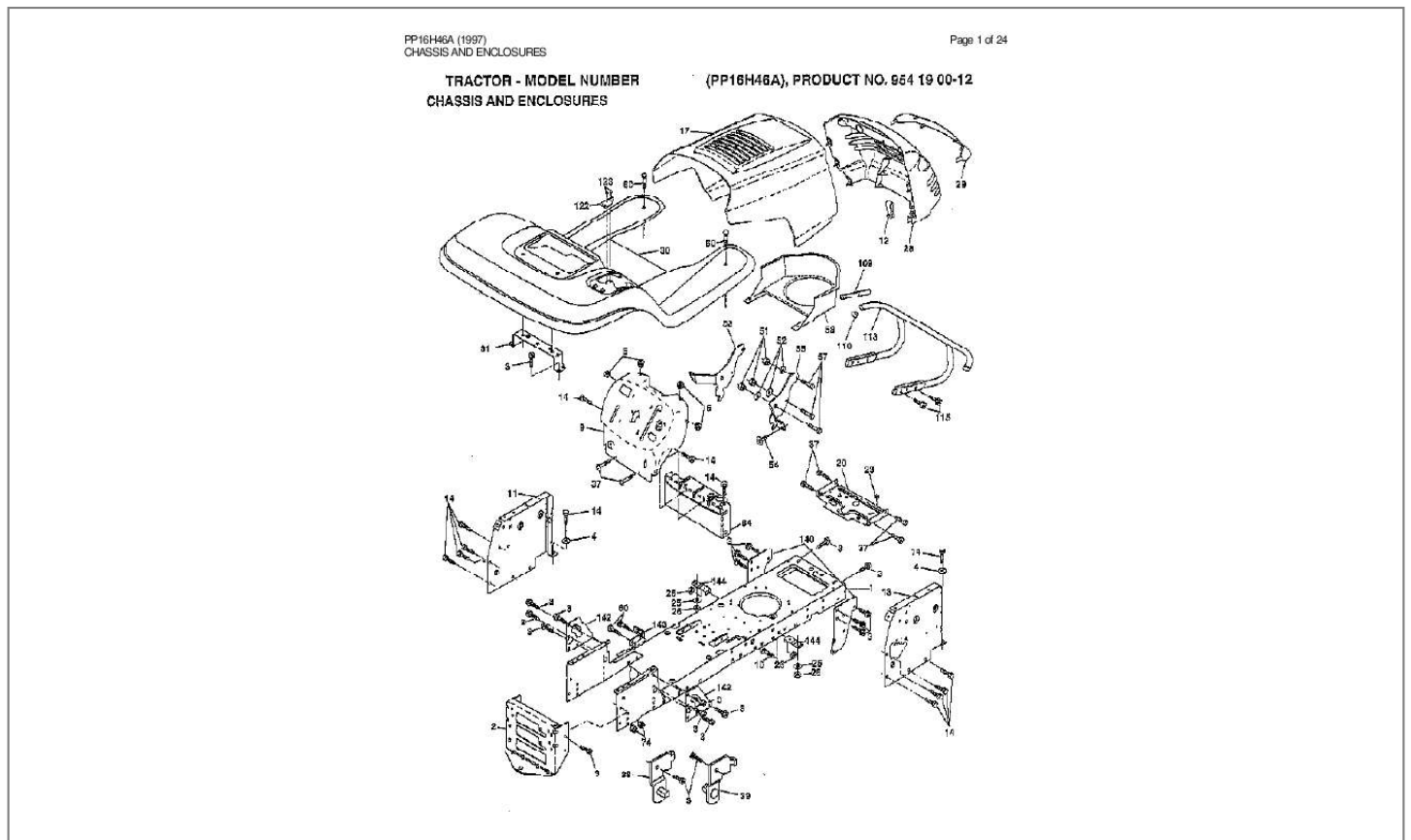

Your PDF Guides

You can read the recommendations in the user guide, the technical guide or the installation guide for AYP PP16H46A. You'll find the answers to all your questions on the AYP PP16H46A in the user manual (information, specifications, safety advice, size, accessories, etc.). Detailed instructions for use are in the User's Guide.

User manual AYP PP16H46A
User guide AYP PP16H46A
Operating instructions AYP PP16H46A
Instructions for use AYP PP16H46A
Instruction manual AYP PP16H46A



[You're reading an excerpt. Click here to read official AYP PP16H46A user guide](http://yourpdfguides.com/dref/439611)
<http://yourpdfguides.com/dref/439611>

Manual abstract:

PLASTIC BUMPER.ASM SCREW "BRKT SHIFT,LT" "SCREW-TT,10-32 FL" BRKT SUSPENSION PLATE.REINFORCEMT "BRKT-S'BAR,CHASSI" BRKT-FOOTREST PLUG BUTTON T Page 2 of 24 PP16H46A (1997) DECALS Page 3 of 24 PP16H46A (1997) DECALS Ref# 1 2 3 4 5 6 7 8 9 10 11 12 13 14 15 20 Part Number 157032 158051 158049 158052 273210 142341 134999 137259 158361 157140 158048 158050 150496 139346 158058 145005 154515 154516 138311 157577 157578 LSB42 LCO5 LCO6 Qty Description "DECAL FENDER,OPER" DECAL FENDER AUTO DECAL HOOD PREDAT "DECAL CHASSIS 46"" DECAL, ENGINE B&S DECAL DRAWBAR LH "DECAL,ENVIRO DECK" "DECAL, WARNING" DECAL FENDER DOME DECAL.CAUT.ENG/FR DECAL INS STRG WH DECAL FENDER PRED RETAINER-SPRING "DECAL.V.BELT.44"" DECAL CHASSIS PRE DECAL.BATRY.3-3908 "PAD-FOOTREST,LH" "PAD-FOOTREST, RH" DECAL HANDLE LIFT MANUAL.

O.PP16H46A MANUAL.O.PP16H46A SNOW THROWER WHEEL WEIGHTS TIRE CHAINS Page 4 of 24 PP16H46A (1997) DRIVE Page 5 of 24 PP16H46A (1997) DRIVE Ref# 1 1 2 3 5 6 8 9 10 13 15 16 18 19 20 21 22 23 24 25 26 27 28 29 30 32 33 34 35 36 37 38 39 40 41 42 47 48 49 50 51 52 53 55 56 57 59 61 62 63 65 66 74 75 76 77 78 81 Part Number PARTSIMAGE SUPPLIER 146682 143995 121520X 17490512 154792 145028 76020416 74550412 74490544 73800500 74780616 73800600 150280 121274X 130804 154978 73350600 106888X 19131316 76020412 145204 71673 130807 74760512 72140506 155071 120183X 19211616 1572H 123674X 74760644 4470J 154777 19131312 127783 154604 123205X 74760624 73680600 73680500 105710X 105709X 74760620 156971 140312 17490612 8883R 145868 10040700 154778 156972 121749X 12000001 123583X 121748X 156969 Qty Description REFER TO PARTS IMAGE CHECK WITH SUPPLIER SPRING.BRAKE.

RETU PULLEY.TRANSAXLE STRAP TORQUE SCREW "ROD SHIFT,FENDER" CLUTCH.ELECT.EVX. PIN COTTER 1/8 BOLT. 1/4-28.W/PAT BOLT.HX.FLG.5/16 NUT BOLT NUT BOLT.7/16-20X4.25 KNOB.DUCKHEAD.1/2 BRAKE ROD BRACKET.CLUT.

MTG. @@@@NUT PUSH M Page 16 of 24 PP16H46A (1997) PEERLESS TRANSAXLE Page 17 of 24 PP16H46A (1997) PEERLESS TRANSAXLE Ref# Part Number 205-026B 36 790075 37 790007 38 799021 39 786026 40 792076A 41 790085 42 792073 42A 792085A 43 792075 44 790025 45 786066 46 790086 71 788069 71A 792162 79 792144 87 788035 180 730229A 189 792168 189A 792169 190 792150 191 792151 208B 798025 209 798024 Qty Description TRANSAXLE, PEERLESS BRAKE DISC PLATE BRAKE PAD BRAKE PAD PIN DOWEL WASHER BRAKE LEVER SCREW, 1/4-20 X 1-1/4 SCREW, 1/4-20 X 2-1/4 LOCKNUT 5/16-24 HOLDER BRAKE PAD SPACER BRAKE LEVER BRACKET SEAL SQUARE CUT PUSHNUT SPRING OIL SEAL GEAR OIL 80W90 DRIVE SCREW SCREW LOCKWASHER NUT FAN/COUPLING CONTROL LEVER Page 18 of 24 PP16H46A (1997) SEAT ASSEMBLY Page 19 of 24 PP16H46A (1997) SEAT ASSEMBLY Ref# 1 2 3 4 5 6 7 8 9 10 11 12 13 14 15 16 17 18 21 22 24 25 Part Number 140118 140551 74760616 19131610 145006 73800600 124181 17490616 19131614 155925 120068X 121246X 121248X 72050411 121249X 123740X 123976X 124238X 153236 73800500 19171912 127018X Qty Description SEAT.2500/1516.BK BRACKET PVT SEAT BOLT WASHER PM CLIP.PUSH-IN.HING NUT SPRING, COMPRESSION, SEAT SCREW GTV WASHER PAN-SEAT "KNOB 1/2"" YT" BRKT SWITCH BUSHING SUB= 872050411 SPACER SPLIT SPRING COMPRESSED SUB= 73900400 CAP SPRING "BOLT,SHOULDER" NUT WASHER "BOLT,SHOULDER" Page 20 of 24 PP16H46A (1997) STEERING ASSEMBLY Page 21 of 24 PP16H46A (1997) STEERING ASSEMBLY Ref# 1 2 3 4 5 6 7 8 9 10 11 13 15 17 18 19 20 22 23 25 27 29 32 33 34 35 36 37 38 39 40 41 42 43 44 46 47 51 54 62 63 65 66 67 68 Part Number 121472X 154427 154422 154423 6266H 121748X 19272016 12000029 3366R 156438 10040600 154779 73901000 156546 57079 124035 126684 71200410 127501 154406 136874 17490612 139929 19111216 10040500 73810500 155099 152927 126805X 19133808 7810H 100711L 145054 121749X 153720 121232X 6855M 73800500 74780520 156594 74780616 154780 154404 74781044 154429 Qty Description SUB= 150546 AXLE ASM SUB= 156483 SUB= 157473 WASHER .T WASHER WASHER RING COL. SRTG. BEAR. @TUBE Page 24 of 24.



[You're reading an excerpt. Click here to read official AYP PP16H46A user guide](http://yourpdfguides.com/dref/439611)

<http://yourpdfguides.com/dref/439611>