

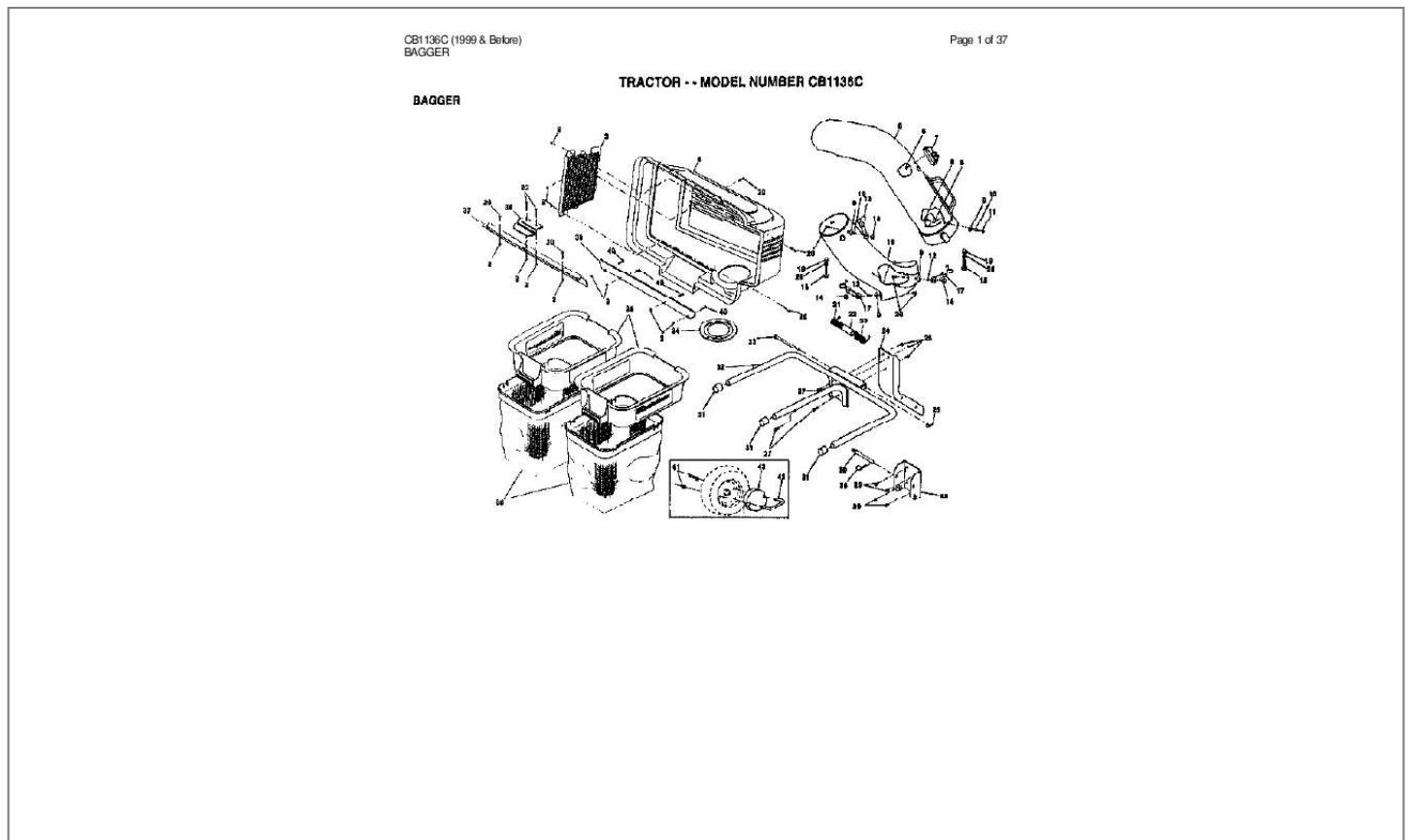

Your PDF Guides

You can read the recommendations in the user guide, the technical guide or the installation guide for AYP CB1136C. You'll find the answers to all your questions on the AYP CB1136C in the user manual (information, specifications, safety advice, size, accessories, etc.). Detailed instructions for use are in the User's Guide.

User manual AYP CB1136C
User guide AYP CB1136C
Operating instructions AYP CB1136C
Instructions for use AYP CB1136C
Instruction manual AYP CB1136C



[You're reading an excerpt. Click here to read official AYP CB1136C user guide](http://yourpdfguides.com/dref/438442)
<http://yourpdfguides.com/dref/438442>

Manual abstract:

UPPER.BAGGE SPECIAL SCREW INDICATOR.DUMP.BG SUB= 74981020 WASHER #10 SPACER LT ACORN NUT RB LOCKWASHER HOOD LATCH T WELDNUT BOLT GT SUB= 160793 "CHUTE.LOWER.36"" ACORN NUT SCREW SPRING.COVER.LH SPACER.COVER.BAGG SPRING COVER RH POST SUPPORT SUB= 73690500 SUB= 85902 BOLT BRACKET.

MTG.BAGGE SCREW LT PIN.SUPT.POST CAP TUBING END FRAME. BAGGER HINGE PIN GASKET.

COVER.BAGG CONTAINER.TOP.BAG CONTAINER BOTTOM SEAL.COVER.

BAGGER LATCH HANDLE SUB= 155042X500 SCREW #10-24X12 NUT U-BOLT "WEIGHT,FRT WHEEL" SUB= 105070X MANUAL.OPER.BAGGE Page 2 of 37 CB1136C (1999 & Before) BRAKE/REAR MOWER LIFT Page 3 of 37 CB1136C (1999 & Before) BRAKE/REAR MOWER LIFT Ref# 1 2 3 4 5 6 7 8 9 10 11 12 13 14 15 16 17 18 19 20 21 22 24 25 26 27 28 29 30 31 Part Number 71673 123436X 123437X 8156H 122504X 76020312 19131016 17490508 76020412 19131316 123543X 139933 123394X 121978X 133332 19251816 12000034 106888X 73350600 73680600 131460 144585 19132012 4921H 73930600 127369 140776 72110506 73510500 3146R Qty Description PLUNGER CAP T "ROD,PARK BRAKE" "BRKT,PARK BRAKE" FOOT PEDAL COVER "BRKT,CLU PEDAL LH" SUB= 3145 WASHER SCREW LT COTTER PIN WASHER "ROD,FRT BRAKE" PEDAL ASM CL/BK36 "ROD,CLUTCH" "BRKT,LIFT SHAFT" PVT BRAKE ARM ASM WASHER T KLIP RING SPRING ROD LT NUT SUB= 73690600 SUB= 532131460 TRUNNION.LIFT. @@@@TUBE T NUT NUT HXKEP 1/4X20 SUB= 146613 DRAWBAR ASM LR "CLIP,INSULATOR" FENDER/FOOT MSS05 WASHER SCREW Page 14 of 37 CB1136C (1999 & Before) FRONT AXLE Page 15 of 37 CB1136C (1999 & Before) FRONT AXLE Ref# 1 2 3 4 5 6 7 8 9 10 11 12 13 14 15 16 17 18 Part Number 121232X 12000029 121748X 3366R 142033 6266H 137062 121749X 76020412 19131316 126847X 130465 137061 74011056 7390100 110438X 6855M 19272016 Qty Description CAP RING WASHER COL. SRTG. BEAR. @WASHER RETAINER.SPRING KEEPER BELT LH BEARING HSG ASM MANDREL BEARING.BALL SUB= 137646 HARDENED WASHER BOLT M5X0.

8X16 GUARD.DFTR.MWR.36 NLA "NUT, M5X0.8" MANDREL ASM DECK.36.LR Page 22 of 37 CB1136C (1999 & Before) MOWER LIFT Page 23 of 37 CB1136C (1999 & Before) MOWER LIFT Ref# 1 2 3 4 5 6 7 8 9 10 11 12 13 14 15 16 17 18 19 20 23 24 25 26 27 28 29 30 31 Part Number 126470X 122018X 71110408 73680600 145187 106451X 135371 74760636 121930X 76020412 19131316 131861 139352 123496X 19131212 4921H 127359 142028 73680400 74760644 76020416 19171612 121933X 141470 106932X 76020312 131655 73350600 19132012 Qty Description "CLIP,INSULATOR" BRKT CLUTCH BOLT HXHD FIN SUB= 73690600 LEVER.ASM.CLUTCH "BOLT, SHOULDER LT" MWR CLUTCH ARM AS BOLT "BELLCRANK,LIFT" COTTER PIN WASHER SUB= 532131861 HANDLE.ASM.

LIFT SPRING COMPRESSIO WASHER T SPRING.RETAINER "LINK,LIFT FRT" TRUNION ADJ SUB= 73690400 BOLT PIN COTTER 1/8 WASHER GT TUBE SPACER ROD LIFT MOWER KNOB T(3/8 HOLE) SUB= 3145 CLUTCH LINK NUT WASHER Page 24 of 37 CB1136C (1999 & Before) SEAT Page 25 of 37 CB1136C (1999 & Before) SEAT Ref# 1 2 4 5 6 8 9 10 11 12 13 14 15 16 18 19 20 22 23 Part Number 72050411 127428X 73680500 139888 145006 74760616 140551 126471X 19133210 73800600 74780814 10040800 19171912 127018X 123976X 121248X 121250X 121246X 140552 Qty Description SUB= 872050411 SUB= 140121 SUB= 73690500 BOLT.SHLD.5/16-18 CLIP.PUSH-IN.

HING BOLT BRACKET PVT SEAT "CLIP,INSULATOR" WASHER NUT BOLT LOCKWASHER WASHER "BOLT,SHOULDER" SUB= 73900400 BUSHING SPRING BRKT SWITCH SUB= 155925 Page 26 of 37 CB1136C (1999 & Before) SECTOR GEAR/AXLE SUPPORT Page 27 of 37 CB1136C (1999 & Before) SECTOR GEAR/AXLE SUPPORT Ref# 1 2 5 6 7 8 9 10 11 12 13 14 15 17 20 21 Part Number 132566 74780828 121926X 121927X 73030800 126472X 73680800 76020412 19131316 126847X 74760512 19111416 72110606 137096 73680600 73680500 Qty Description DRAG LINK "BOLT,HEX" GEAR SECTOR BUSHING NUT CLIP INSULATOR NUT LTV COTTER PIN WASHER BUSHING.DRAGLINK BOLT WASHER BOLT SUPT AXLE FRONT SUB= 73690600 SUB= 73690500 Page 28 of 37 CB1136C (1999 & Before) STEERING Page 29 of 37 CB1136C (1999 & Before) STEERING Ref# 1 2 3 4 5 6 7 8 9 10 11 12 13 Part Number 133742 7810H 19133808 133741 121897X 17431008 102803X 123651X 124210X 123438X 12000045 19211616 104820X Qty Description ST WHL INSERT CAP GRIPCO NUT WASHER T SUB= 150547 SLEEVE STEERING SUB= 98000165 SUB= 918102803X SUB= 148966 STEERING CLIP BUSHING STEER LWR RING WASHER LT ADAPTER-WHEEL LT Page 30 of 37 CB1136C (1999 & Before) TRANSAXLE Page 31 of 37 CB1136C (1999 & Before) TRANSAXLE Ref# 1 2 3 4 5 6 7 8 9 10 11 12 15 16 17 18 19 20 21 22 23 24 25 26 28 29 31 33 35 36 Part Number 123385X 12000028 142602 2228M 73680500 72140506 123378X 17490512 146682 121749X 123583X 74760644 19171616 124600X 123632X 74550412 10040400 19091210 123484X 105701X 106933X 128215 76020416 73810500 128085 128084 109502X 73680600 12000001 17720408 Qty Description PULLEY SUB= 2267J SUB= 160851 SUB= 2228M1 SUB= 73690500 BOLT "STRAP,TORQUE" SCREW SPRING.BRAKE.RETU WASHER SQUARE KEY BOLT WASHER "SUPT,HDLE SHT LH" "LINK,SHIFT" BOLT.1/4-28.

W/PAT LOCKWASHER WASHER LT ARM SHIFT WASH-SHFT PLT LT KNOB T (1/2-HOLE) "ROD,SHIFT" PIN COTTER 1/8 NUT.LOCK.5/16-24 "SPRING,EXT" "SUPT,HDLE RH" SPACER LT SUB= 73690600 E-RING LT SCREW Page 32 of 37 CB1136C (1999 & Before) TRANSAXLE Page 33 of 37 CB1136C (1999 & Before) TRANSAXLE Ref# 1 2 3 4 5 6 7 8 9 10 11 12 13 14 15 16 17 18 19 20 21 22 23 24 25 26 27 28 29 30 31 32 33 34 35 36 37 38 39 40 41 42 43 44 45 46 47 48 49 50 51 52 53 54 55 56 57 58 Part Number 142671 2274J 134400 105904X 105905X 138235 134399 120951X 143045 142672 134793 143051 120415X 142674 138234 110078X 105909X 105910X 105911X 142675 138246 138236 134791 142676 2244J 105916X 120470X 110070X 142677 120405X 108980X 120406X 134796 134797 105925X 2232J 108978X 110079X 124639X 120472X 105928X 110084X 134394 120473X 142678 120407X 106589X 120408X 105937X 105936X 2226J 134401 2264J 120474X 110081X 105941X 110071X 120952X Qty Description HOUSING UPPER TRN SUB= 74760412 SUB= 68003 "SPRING, DETENT LT" "SCREW, SET LT" KIT SHIFTER ASM SHIFTER BOOT PUCK T SEAL OIL DANA5416 SUB= 2225J ASM KIT SHIM 4689 SUB= 148268 WASHER T KEY WOODRUFF-DANA AS KIT INPUT SHFT PINION 14T.



[You're reading an excerpt. Click here to read official AYP CB1136C](http://yourpdfguides.com/dref/438442)

[user guide](http://yourpdfguides.com/dref/438442)

<http://yourpdfguides.com/dref/438442>