

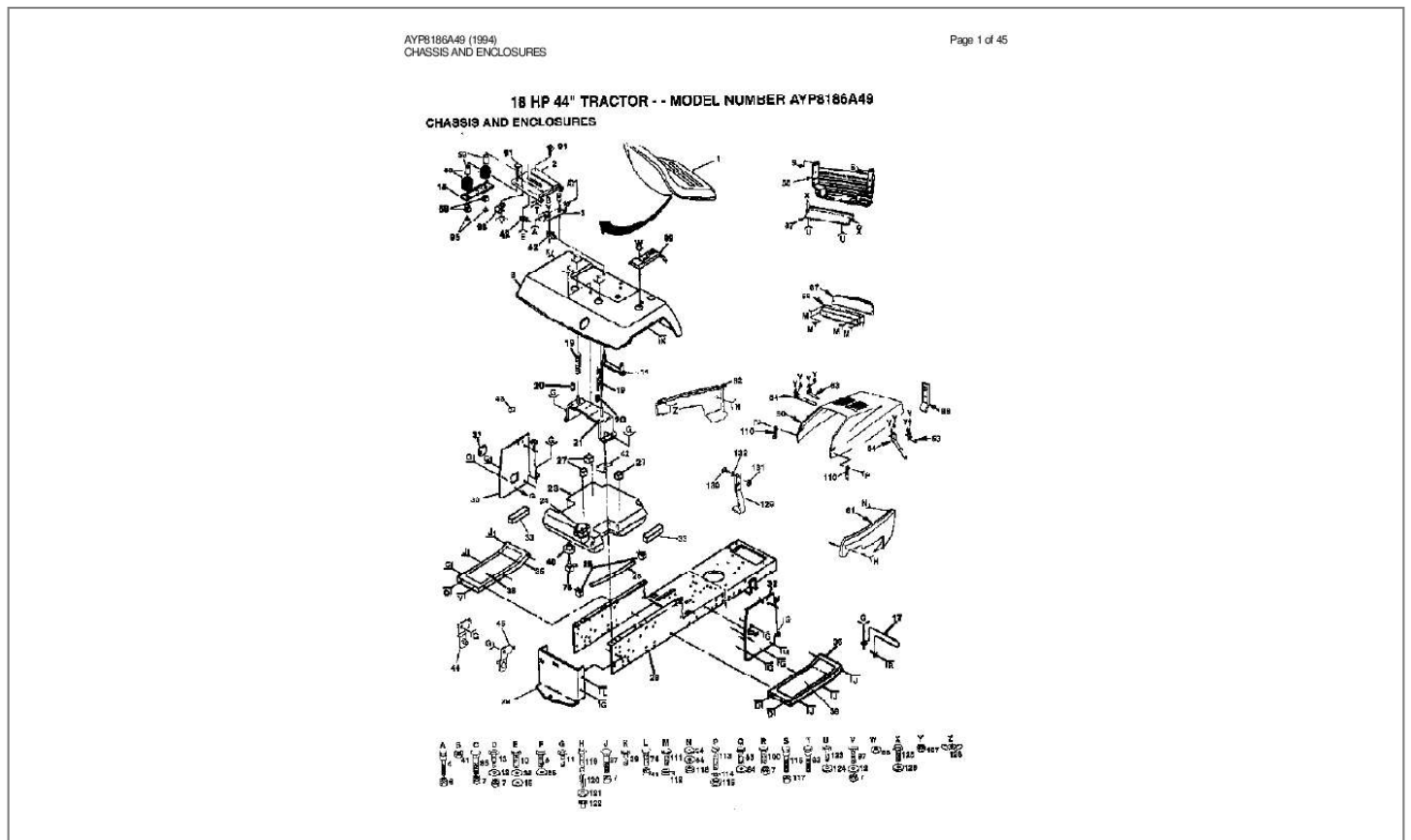

# Your PDF Guides

You can read the recommendations in the user guide, the technical guide or the installation guide for AYP AYP8186A49. You'll find the answers to all your questions on the AYP AYP8186A49 in the user manual (information, specifications, safety advice, size, accessories, etc.). Detailed instructions for use are in the User's Guide.

**User manual AYP AYP8186A49**  
**User guide AYP AYP8186A49**  
**Operating instructions AYP AYP8186A49**  
**Instructions for use AYP AYP8186A49**  
**Instruction manual AYP AYP8186A49**



[You're reading an excerpt. Click here to read official AYP AYP8186A49 user guide](http://yourpdfguides.com/dref/438226)  
<http://yourpdfguides.com/dref/438226>

**Manual abstract:**

ASM.FENDER SUB= 151346 CAP ASM FUEL HOSE CLAMP FUEL LINE T PAD-SPACER LT SUB= 145501 DRAW BAR PANEL.DASH.LH COVER ACCESS PANEL.DASH.RH PAD IDLER TI LOCKWASHER SUB= 145244X505 SUB= 145243X505 BOLT FOOTREST PAD SCREW LT BUSHING OUTLET T NUT CLIP PUSH - IN SUB= 9151R BRACKET ASM LH BRACKET ASM RH SUB= 150301X505 WASHER PM SUB= 532131716 BUSHING SPACER SPLIT SPRING COMPRESSED PANEL.SIDE.RH SIDE PANEL LH SUB= 155013 SUB= 155013 LENS LT SUB= 147717 SUB= 74780612 SUB= 139277 WASHER NUT Page 2 of 45 AYP8186A49 (1994) CHASSIS AND ENCLOSURES Ref # 87 88 91 93 95 96 97 99 110 111 112 113 114 115 116 117 118 119 120 121 122 123 124 125 126 127 128 129 130 131 132 Part Number 105419X418 132644 72050411 127018X 123976X 72140608 74760614 139991 109808X 17211010 104755X 74191008 10071000 2029J 123481X 73680400 73220400 74981020 7206J 19070818 73731000 17490512 19131210 17490412 19091016 73510400 123198X 142992 72240608 73800600 19131612 Qty Description STRAP.GRILLE SUB= 532132644 SUB= 872050411 "BOLT,SHOULDER" SUB= 73900400 SUB= 72110608 SUB= 74760616 CONSOLE SHIFT HOOD LATCH T SCREW LT """"J"""" FASTENER LT" SCREW LOCKWASHER WELDNUT SUB= 7605J SUB= 73690400 SUB= 50675 SCREW SPACER LT WASHER NUT SCREW WASHER SCREW HEX CRT WASHER NUT SUB= 146525 STOP.OVER.

CENTER BOLT NUT WASHER GT Page 3 of 45 AYP8186A49 (1994) DECALS Page 4 of 45 AYP8186A49 (1994) DECALS Ref # 1 2 3 4 5 6 7 8 9 10 11 13 14 15 1 2 3 4 4 5 5 6 6 7 7 8 9 Part Number 138955 141557 141556 141558 106202X 133796 4900J 141561 140837 141517 141654 133780 127520 139346 138311 141937 59192 65139 278H 106230X 124106X 59904 7154J 106228X427 106277X427 104757X 9040H 121748X Qty Description DECAL.DASH.INST. DECAL HD LH WIZ + DECAL HD RH WIZ + DECAL PANEL SIDE REFLECTOR-TAIL YT DECAL DECAL T DECAL CHASSIS DECAL BRAK PARK DECAL DECK WIZ + DECAL STEER WHL NLA NLA "DECAL.V.

BELT.44"""" DECAL HANDLE LIFT MANUAL.O.8186A49 VALVE CAP VALVE STEM LT FITTING LT SUB= 122075X SUB= 138756 TUBE.5. 3/4.5/6 TUBE.23X8/10-12 "RIM ASM 8"" FRT" "RIM ASM 12"" REAR" HUB CAP "FLANGE, BEARING" WASHER Page 5 of 45 AYP8186A49 (1994) DRIVE Page 6 of 45 AYP8186A49 (1994) DRIVE Ref # 1 2 3 4 5 6 7 8 9 11 13 14 15 16 17 19 20 21 22 23 24 25 26 27 28 29 30 31 32 33 34 35 36 37 38 39 40 41 42 43 44 45 46 47 48 49 50 51 52 53 54 55 56 57 58 59 60 61 Part Number 121327X 12000004 2228M 138788 72140506 19111012 71208 126197X 17490628 137978 122434X 122435X 123796X 106933X 123781X 105701X 19171216 76020416 17490612 121218X 74760616 19131312 73680600 8883R 122424X 1572H 19211616 122439X 123792X 137140 140312 109070X 4470J 123674X 74760644 136906 10040700 71170768 123791X 17190408 123776X 120183X 71040412 19091216 143600 73680500 74780544 123787X 123780X 123794X 76020412 133261 123786X 124236X 126909X 19131316 Qty Description PULLEY TRANSAXLE RING SUB= 2228MI TRANSAX. PRLES. BOLT WASHER T BUSHING REFER TO IMAGE WASHER SCREW LT CHECK WITH SUPPLIER SUB= 149723 TUBE ASSY EXH LH TUBE ASSY EXH RH BELT.GRDRV.94.75 KNOB T (1/2-HOLE) SUB= 141002 WASH-SHFT PLT LT WASHER PIN COTTER 1/8 SCREW KEEPER BELT ENGLH BOLT WASHER SUB= 73690600 PEDAL COVER T SUB= 149001 SUB= 2882J WASHER LT BRACKET MUFFLER "KEEPER,BELT RH" SUB= 142600 KEEPER BELT CNTSP BELT KEEPER LT SPACER T PULLEY.IDLER.FLAT BOLT PULLEY ENGINE LOCKWASHER SUB= 150280 KEEPER BELT LH SCREW ST BRKT TRANS RH NYLON BEARING SUB= 74550412 WASHER PM SHIELD HEAT LT SUB= 73690500 BOLT HEX STRAP TORQUE BRKT TRANS LH "ARM,SHIFT" COTTER PIN BRAKE PARK ROD ROD BRAKE CAP "SPRING,ROD BRAKE" WASHER Page 7 of 45 AYP8186A49 (1994) DRIVE Ref # 62 63 64 65 66 67 68 69 70 71 72 73 74 75 76 77 78 79 80 81 82 83 84 85 88 89 90 91 92 93 94 97 98 100 101 102 103 104 105 106 108 112 116 117 Part Number 123800X 19132012 128953 127783 123789X 123205X 74760624 110812X 12000039 105709X 105710X 73530400 132747 17720410 123650X 133746 105838X 105839X 105730X 108097X 19111216 12000053 73800600 9396E 19212016 74760612 105706X 12000008 123772X 123782X 11050600 73800600 137141 19132012 17490512 2751R 123793X 137180 110422X 4497H 13280336 13200300 17021008 73350600 Qty Description WASHER WASHER HEAT SHIELD SUB= 139245 ARM IDLER RETAIN BELT SUB= 74930624 WASHER LT KLIP RING "SPRING, RETURN LT" "LINK, CLUTCH T" NUT 1/4-28 SUB= 532132748 SCREW LT STUD.

1/4.TURN HEAT SHIELD RETAINER LT RECEPTACLE LT "KEEPER,BLT ENG LT" SPACER HYT WASHER M E RING HYT NUT SQ KEY STD WASHER D SUB= 74780612 "LY, BEARING" KLIP RING "SHAFT,SHIFTER" "SPRING,TORSION" LOCKWASHER NUT BRACKET.ASM.MTG WASHER SCREW CLIP T "ROD,TIE " SUB= 532137180 SUB= 146682 RETAINER M PIPE NIPPLE LT ELBOW SCREW NUT Page 8 of 45 AYP8186A49 (1994) ELECTRICAL Page 9 of 45 AYP8186A49 (1994) ELECTRICAL Ref # 1 2 3 4 5 6 7 8 9 10 11 12 14 19 20 21 22 23 24 25 26 28 29 30 31 32 33 34 35 36 37 40 41 42 43 44 45 46 50 51 70 Part Number 121537X 74760412 19091016 10040400 121264X 73220400 7697J 7603J 109596X 72240460 102476X 123198X 19121618 10090400 73350400 136850 4152J 11150400 4206J 4206J 108824X 4207J 121305X 140399 140400 123620X 140401 110712X 108236X 17021008 104445X 140420 71110408 131563 138406 73680400 122822X 141940 140404 140405 140424 Qty Description SUB= 123899X BOLT LT WASHER LOCKWASHER "CAP,BATTERY " SUB= 50675 "DRAIN TU T, BATT" "TRAY T, BATTERY" HOSE CLAMP T BOLT SUB= 150109 SUB= 146525 WASHER.3/4X1X18GA SUB= 10040400 NUT "HARNESS,LIGHT SOC" HEADLAMP BULB LOCKWASHER CABLE-BATTERY T CABLE-BATTERY T FUSE HYT CABLE T SWITCH SEAT SUB= 163088 SUB= 145774 SUB= 141226 KEY MLD GEN DELTA SWITCH LT BRACKET LT SCREW SWITCH-INTER. @@NUT, HEX COVER, VALVE COVER, VALVE OIL PUMP ASSEMBLY SLIDER, GOVERNOR ROD, PUSH, INTAKE ROD, PUSH, EXHAUST FILTER, OIL ADAPTER, OIL FILTER ARM, ROCKER SHAFT, ROCKER ARM SUPPORT, ROCKER ARM OVERHAUL KIT,05416 808022 805529 807862 805631 805009 805402 805103 805483 807805 805505 805641 224356 805675 280104 807685 394856 490310 399172 805057 805317 805012 221798 807859 805083 805738 805094 805085 805086 805084 490467 Qty Description PUMP, FUEL SCREW, SEMS CARTRIDGE, AIR CLEANER KNOB, AIR CLEANER STATOR, ALTERNATOR REGULATOR, ALTERNATOR STARTER DRIVE GROUP CLUTCH ASSEMBLY TERMINAL, SPADE DIPSTICK SEAL, FILLER TUBE TUBE, OIL FILLER SCREW, REGULATOR MOUNTING CLAMP, FUEL PUMP ELEMENT, AIR CLEANER GASKET, AIR CLEANER ARMATURE ASSEMBLY BUSHING, GOVERNOR SHAFT BUSHING, GOVERNOR SHAFT BOLT BAFFLE, BREATHER BACK PLATE ASSEMBLY NUT, HEX CLAMP, HOSE, GREEN SCREW, SEMS PIN, COTTER FORK, GOVERNOR WASHER, GOVERNOR SHAFT SHAFT SEAL KIT ELBOW, SPARK PLUG COVER ASSEMBLY, AIR CLEANER PLATE, AIR FILTER SCREW, SEMS SPACER, ROTATING SCREEN DOWEL, CRANKCASE SEAL, BREATHER SCREW GEAR, FLYWHEEL RING SHIELD, STARTER GROMMET, IGNITION CABLE CLIP, DEBRIS GEAR, TIMING GEAR, STARTER BRACKET, FUEL PUMP CAP, DRIVE CAP ASSEMBLY, COMMUTATOR END HOUSING ASSEMBLY SCREW, SEMS SCREW, MOUNTING O-RING TERMINAL, IGNITION CABLE BRACKET, AIR CLEANER LINER, EXHAUST PORT VALLEY, COVER, AIR GUIDE SEAL, VALVE GUIDE SEAL, INTAKE VALVE SEAT, EXHAUST VALVE GUIDE, VALVE PINION SPRING KIT Page 19 of 45 AYP8186A49 (1994) ENGINE/B&S Ref # 879 883 896 947 975 977 978 982 985 1003 1004 1005 1006 1014 1022 1023 1024 1025 1026 1027 1028 1029 1030 1031 1033 1036 1037 Part Number 805636 805024 94288 494312 807913 807916 805250 805030 398525 490316 805632 807863 224413 807797 805028 805100 807665 807546 805313 805352 805617 492932 805292 807557 805342 805341 807910 807688 807915 Qty Description COVER, CARBURETOR GASKET, EXHAUST MANIFOLD ROLL PIN SOLENOID BOWL, FUEL ASSEMBLY GASKET SET, CARBURETOR GASKET, OIL FILTER ADAPTOR SCREW, SEMS INSULATOR ASSEMBLY BRUSH SPRING SET TUBE, AIR INLET FAN, FLYWHEEL RETAINER, FAN DEFLECTOR, BREATHER, A.



[You're reading an excerpt. Click here to read official AYP  
AYP8186A49 user guide  
http://yourpdfguides.com/dref/438226](http://yourpdfguides.com/dref/438226)

C. @@@@Belt-V.88.12.

MW SPRING.EXT.DECK. @SRTG. BEAR.

SUB= 532130468 LOCKWASHER SUB= 7810H SUB= 155108 SUB= 98000165 CLIP T CAP ZERK M SCREW Page 39 of 45 AYP8186A49 (1994)  
STEERING Ref # 78 79 80 82 84 86 87 88 89 90 91 94 95 97 Part Number 19111116 73510500 19272016 122819X 19111216 10040400 71070410 132624  
19131316 124130X 74760612 19091216 73220400 19131312 Qty Description WASHER NUT WASHER SCREW SPECIAL WASHER M LOCKWASHER  
"SCREW,SPECIAL" AXLE PIN WASHER SUPPORT ASS'Y SUB= 74780612 WASHER PM SUB= 50675 WASHER Page 40 of 45 AYP8186A49 (1994)  
TRANSAXLE Page 41 of 45 AYP8186A49 (1994) TRANSAXLE Ref # Part Number 794513 1 772098A 2 780155 3 770088 4 776291 5 776275 6 778247 7  
778253 8 792138 9 784216 10 784342 11 778246 12 778245 13 778198 14 778197 15 778248 16 786027 17 786019 18 786121 18A 786122 20 792077 21  
792078 22 792079 24 780071 25 792129 25A 792073 26 792018 27 792018 28 788040 29 780072 30 780108 31 780128 31A 780107 31B 780042 36 790043  
37 790007 38 799021 39 786026 40 792076A 41 790047 42 792073 42A 792085A 43 792075 44 790025 45 786067 46 786086 47 774832 48 774831 49  
778216A 50 778206A 51 778205A 52 778204A 53 778203A 54 778273 57 778199 58 778200 59 778201 60 778202 Qty Description TRANSAXLE,  
COMPLETE COVER TRANSAXLE BEARING NEEDLE CASE TRANSAXLE SHAFT COUNTER SHAFT, OUTPUT, 9T GEAR, OUTPUT, 35T GEAR, SPUR,  
15T KEY COLLAR SHIFT ROD AND FORK ASSY SHIFT GEAR BEVEL, 33T BEVEL PINION, 13T GEAR BEVEL PINION, 10T GEAR, RING, 31T BLOCK  
DRIVE PIN DRIVE SPACER, .350/.340 THICK SPACER, .276/.268 THICK BALL STEEL, 5/16" DIA.  
SCREW, 3/8-16 X 3/8" SPRING THRUST BEARING SCREW HEX HD 5/16-18 X 1-1/4 SCREW, 1/4-20 X 1-1/4 RING STRAP RING STRAP RETAINING  
RING WASHER THRUST WASHER THRUST WASHER THRUST WASHER THRUST DISK BRAKE PLATE BRAKE PAD BRAKE PAD PIN  
DOWEL WASHER LEVER BRAKE SCREW, 1/4-20 X 1-1/4 SCREW, 1/4-20 X 2-1/4 LOCKNUT 5/16-24 HOLDER BRAKE PAD SPACER BRKT BRAKE  
LEVER AXLE, 12-5/16" LONG AXLE, 16-3/16" LONG GEAR, SPUR, 41T GEAR, SPUR, 35T GEAR, SPUR, 30T GEAR, SPUR, 25T GEAR, SPUR, 22T  
GEAR, SPUR, 19T GEAR, SPUR, 15T GEAR, SPUR, 20T GEAR, SPUR, 25T GEAR, SPUR, 28T Page 42 of 45 AYP8186A49 (1994) TRANSAXLE Ref # 61 65  
66 67 71 71A 72 79 81 82 83 84 87 88 89 90 96 97 98 99 100 101 102 103 104 105 106 107 108 109 110 111 112 113 114 115 116 117 150 Part Number  
778208 780139 776274 776313 788069 792145 792074 792144 786081 786082 786123 786131 788042 780119 780050 788067B 780084 780051 780165  
788077 780166 774833 774834 792020 792006 780153 786144 780152 780150 792001 786142 788071 780168 786143 780151 786145 788070 780031  
510334 Qty Description GEAR, SPUR, 31T WASHER SHAFT INPUT SHAFT BRAKE SEAL SQUARE CUT PUSHNUT PLUG, THRDDED, 9/16-18 SPRING  
CHAIN, ROLLER SPROCKET 9T SPROCKET 18T (REV) BEARING CAP OIL SEAL 3/4 BEARING BALL BEARING BALL GREASE BENTONITE, 32 OZ. .



[You're reading an excerpt. Click here to read official AYP](#)

[AYP8186A49 user guide](#)

<http://yourpdfguides.com/dref/438226>