

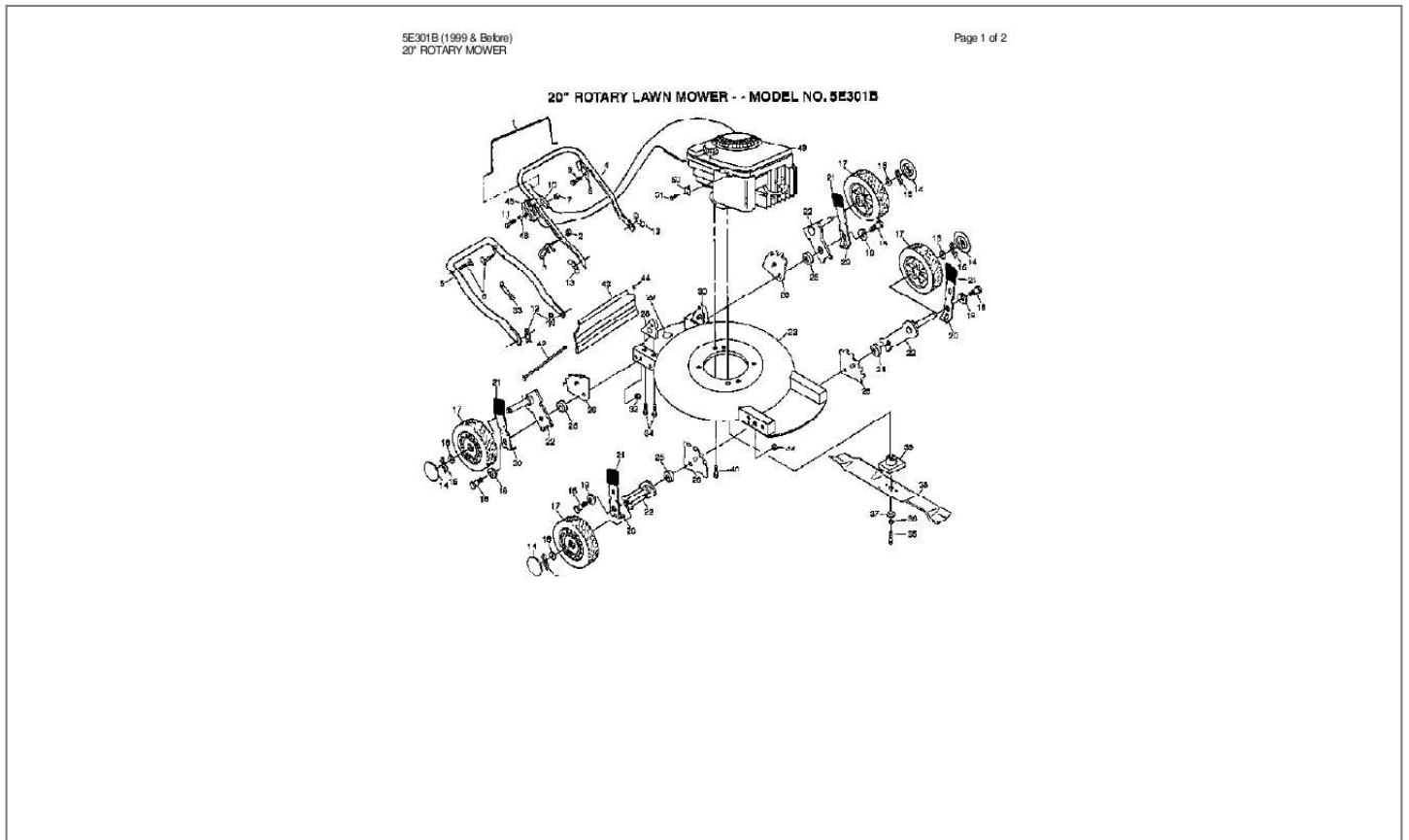

Your PDF Guides

You can read the recommendations in the user guide, the technical guide or the installation guide for AYP 5E301B. You'll find the answers to all your questions on the AYP 5E301B in the user manual (information, specifications, safety advice, size, accessories, etc.). Detailed instructions for use are in the User's Guide.

User manual AYP 5E301B
User guide AYP 5E301B
Operating instructions AYP 5E301B
Instructions for use AYP 5E301B
Instruction manual AYP 5E301B



[You're reading an excerpt. Click here to read official AYP 5E301B user guide](http://yourpdfguides.com/dref/437660)
<http://yourpdfguides.com/dref/437660>

Manual abstract:

HANDLE.LM SUB= 73800400 "BRKT,UPSTOP" TAPPING SCREW "CABLE,ENG ZONE CO" SUB= 144929 HAIRPIN COTTER "NUT,WING PM" HUB
CAP RETAINER CLIP PM WASHER SUB= 146247 SUB= 142748 "WASHER, BELLEVIL." SPRING SELECTOR KNOB PM AXLE ARM "KIT.HSG.20"
MULCH" SUB= 146630 BRACKET.ADJ.9POS. .



[You're reading an excerpt. Click here to read official AYP 5E301B
user guide](#)

<http://yourpdfguides.com/dref/437660>